

- APPLICABLE CODES, REGULATIONS & STANDARDS
1. 2023 FLORIDA BUILDING CODE, BUILDING (8TH EDITION)
 2. 2023 FLORIDA BUILDING CODE, RESIDENTIAL (8TH EDITION)
 3. ASCE 7-22: MINIMUM DESIGN LOADS ON BUILDINGS AND OTHER STRUCTURES
 4. ACI 318-19: BUILDING CODE REQUIREMENTS FOR STRUCTURAL CONCRETE
 6. 2020 ALUMINUM DESIGN MANUAL

WIND LOADS (SEC 1609)

1. RISK CATEGORY = II
2. BASIC WIND SPEED = 160 MPH
3. EXPOSURE CATEGORY = D

LIVE LOADS FOR NON-RESIDENTIAL STRUCTURES (SEC 1607.8)

1. GUARDRAILS AND HANDRAILS
 - A. LINEAR LOAD OF 50 PLF
 - B. CONCENTRATED LOAD OF 200 LBF
2. INTERMEDIATE RAILS
CONCENTRATED LOAD OF 50 LBF

LIVE LOADS FOR RESIDENTIAL STRUCTURES (TABLE R301.5)

GUARDS AND HANDRAILS = 200 PSF
GUARD IN-FILL COMPONENTS = 50 PSF

GENERAL NOTES AND SPECIFICATIONS

1. THE STRUCTURES INDICATED HEREIN ARE DESIGNED TO BE INSTALLED WITHIN MASONRY OR WOOD FRAME HOST STRUCTURES OF ADEQUATE STRUCTURAL CAPACITY. THE CONTRACTOR SHALL VERIFY THAT THE HOST STRUCTURE IS IN GOOD CONDITION AND OF SUFFICIENT STRENGTH TO SUPPORT THE PROPOSED ADDITION.
2. ALUMINUM EXTRUSIONS SHALL MEET THE STRENGTH REQUIREMENTS OF ASTM B221 AFTER POWDER COATING.
3. ALL ALUMINUM EXTRUSIONS ARE TO BE A MINIMUM 6005-T5.
4. SITE SPECIFIC ENGINEERING REQUIRED FOR ALL INSTALLATIONS ABOVE AN ELEVATION OF 60 FT FROM GRADE.
5. THE SCHEMATIC SHOWN ON PAGE 1 AS WELL AS THE DETAILS ON THE FOLLOWING PAGES ARE DESIGNED BASED ON THE PROVISIONS OF THE BUILDING CODE.
6. CABLES TO BE ATTACHED TO FRAME MEMBERS USING PUSH-LOCK TOGGLE TENSIONER ON ONE SIDE AND PUSH-LOCK TOGGLE NON-TENSIONER ON THE OTHER SIDE, WITH A WORKING LOAD RATING OF 750 LBF. SEE MANUFACTURER'S SPECIFICATIONS FOR DETAILS.

TABLE A - FOR TOTAL WIDTH<=16'-0"
(TO BE USED FOR INSTALLATIONS WITH NON-EPOXY ANCHORS, SEE PAGE 2A)

| NUMBER OF PANELS | MAXIMUM PANEL WIDTH | DISTANCE BETWEEN FULL-LENGTH POSTS |
|------------------|---------------------|------------------------------------|
| 1 | 5'-6" | 5'-6" |
| 2 | 5'-1" | 10'-2" |
| 3 | 4'-8" | 14'-0" |
| 4 | 4'-0" | 16'-0" |

TABLE B - FOR TOTAL WIDTH>=16'-0"
(TO BE USED FOR INSTALLATIONS WITH EPOXY ANCHORS, SEE PAGE 2B)

| NUMBER OF PANELS | MAXIMUM PANEL WIDTH | DISTANCE BETWEEN FULL-LENGTH POSTS |
|------------------|---------------------|------------------------------------|
| 3 | 5'-4" | 16'-0" |
| 4 | 5'-3" | 21'-0" |

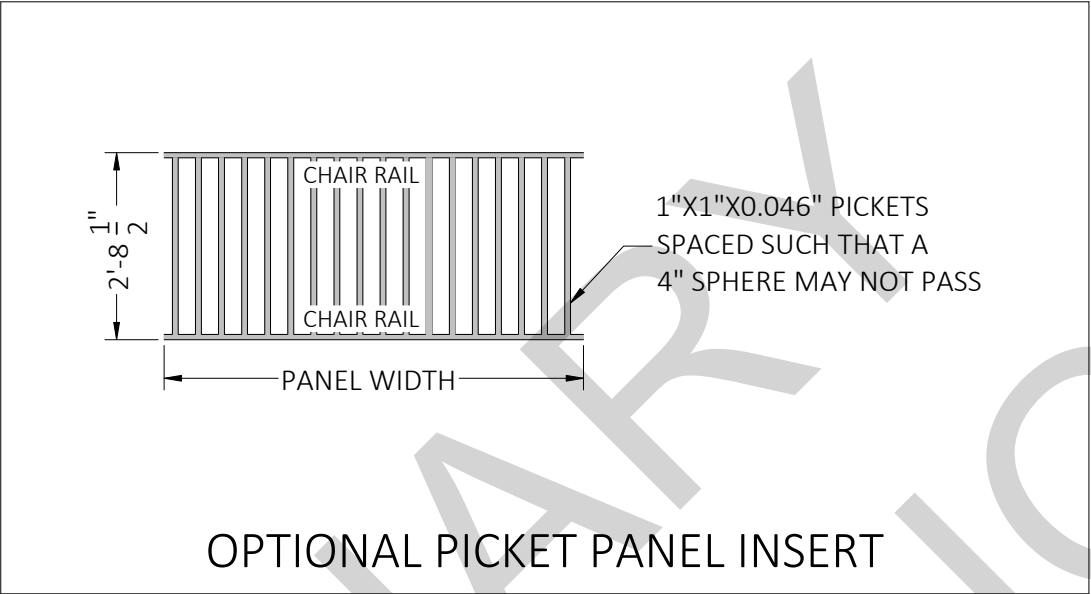

OPTIONAL PICKET PANEL INSERT

THE APPLICABILITY OF THIS DESIGN FOR ANY
SITE-SPECIFIC PROJECT REQUIRES THE SIGN & SEAL OF A
PROFESSIONAL ENGINEER.

MEMBER LEGEND

| NO. | MEMBER | SECTION LABEL |
|-----|-------------------|------------------------------|
| 1 | PERIMETER CHANNEL | SECTION A |
| 2 | FULL-LENGTH POST | SECTION B |
| 3 | CHAIR RAIL | SECTION B |
| 4 | INTERMEDIATE POST | SECTION B |
| 5 | WIRE ROPE | 1/8" X 1-19 CABLE (316 S.S.) |

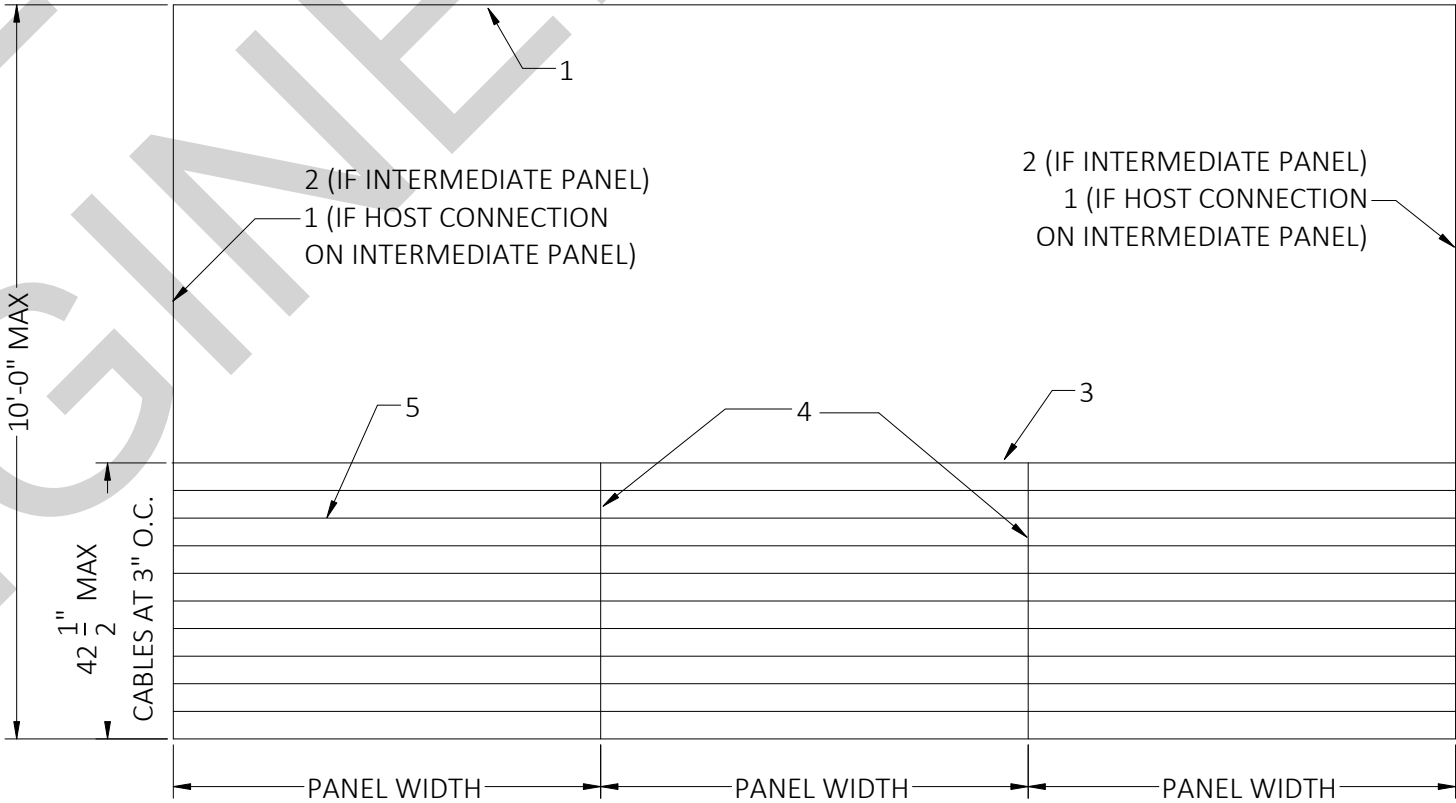

TYPICAL PANEL LAYOUT

FLORIDA ENGINEERING LLC 4161
TAMIAMI TRAIL, UNIT 101
PORT CHARLOTTE, FLORIDA 33952
(941) 391-5980
www.FLEng.com



CA CERT. #30782

PROJECT NO. 2023126-17

CONTRACTOR:
TAYLOR MADE
EXTRUSIONS, INC.

PROJECT DESCRIPTION:
MASTER PLAN

DESIGN DATE: 05/01/2025

REVISION 1: DATE

REVISION 2: DATE

DRAWN BY: KHV

SCALE: NTS

PAGE :

1A

| | | |
|------------------|---------------------|------------------------------------|
| NUMBER OF PANELS | MAXIMUM PANEL WIDTH | DISTANCE BETWEEN FULL-LENGTH POSTS |
| 2 | 6'-0" | 12'-0" |

| | | |
|------------------|---------------------|------------------------------------|
| NUMBER OF PANELS | MAXIMUM PANEL WIDTH | DISTANCE BETWEEN FULL-LENGTH POSTS |
| 2 | 6'-0" | 12'-0" |

| NO. | MEMBER | SECTION SIZE |
|-----|-------------------|------------------------------|
| 1 | PERIMETER CHANNEL | SECTION A |
| 2 | FULL-LENGTH POST | SECTION B |
| 3 | CHAIR RAIL | SECTION B |
| 4 | INTERMEDIATE POST | SECTION B |
| 5 | WIRE ROPE | 1/8" X 1-19 CABLE (316 S.S.) |
| 6 | FLAT BAR | 1" X 1/4" |

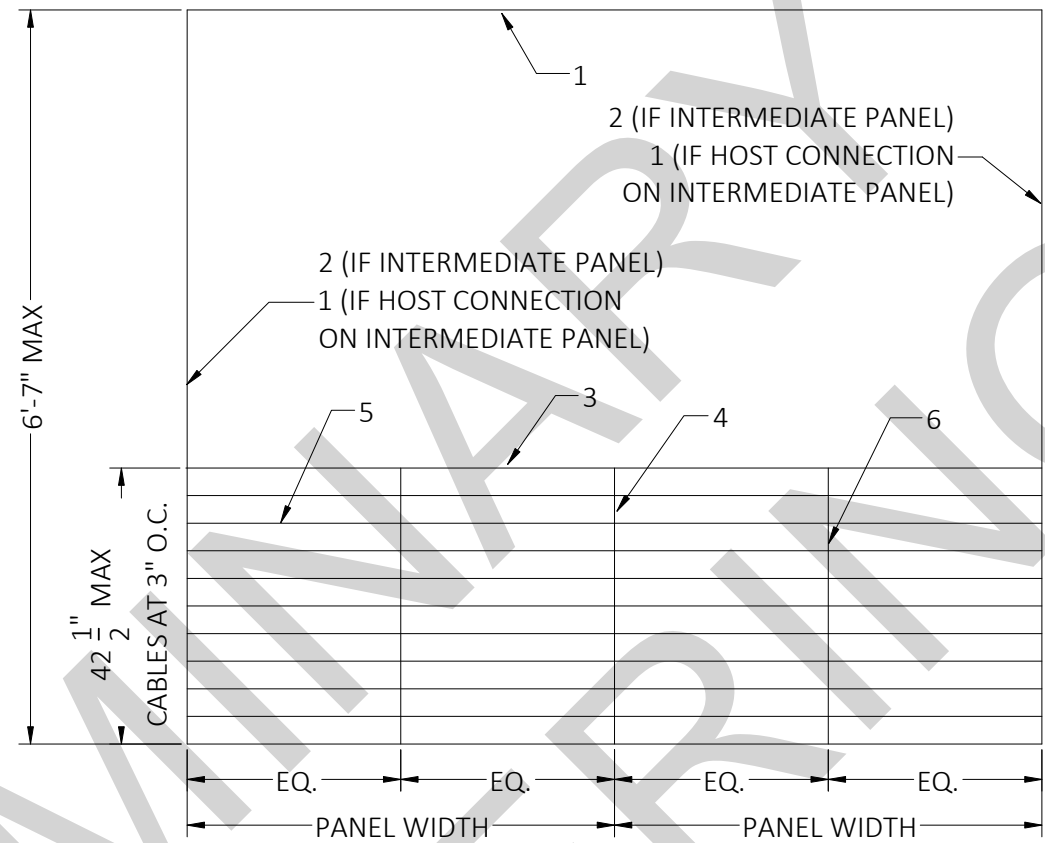

TYPICAL PANEL LAYOUT

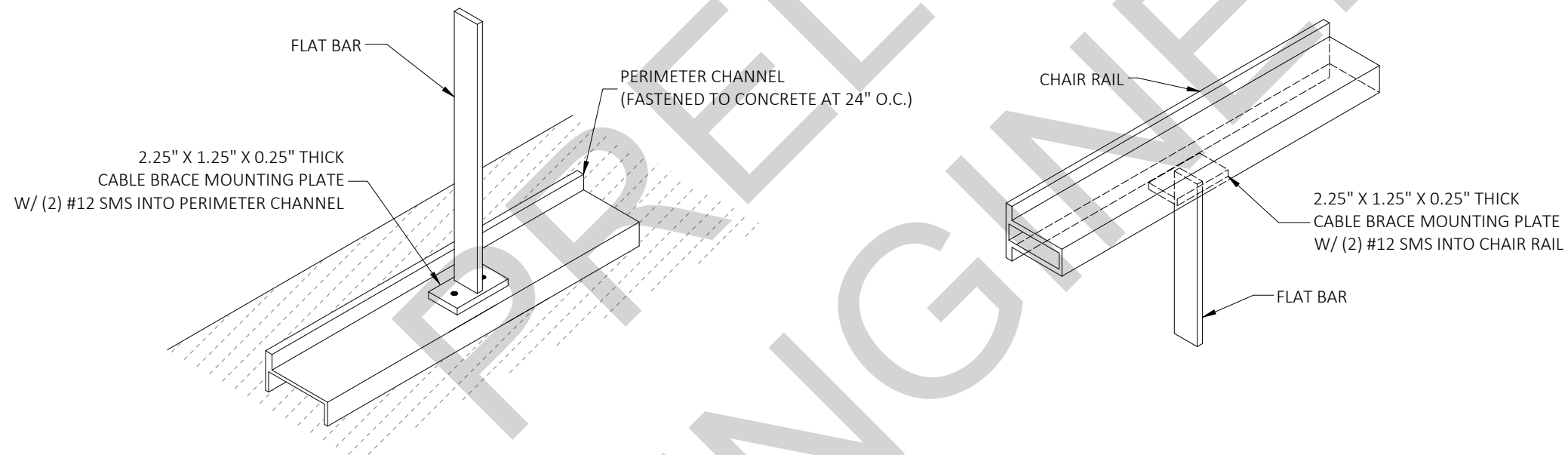

PANEL LAYOUT - (2) PANEL SPECIAL CASE

FLORIDA ENGINEERING LLC 4161
TAMIAMI TRAIL, UNIT 101
PORT CHARLOTTE, FLORIDA 33952
(941) 391-5980
www.FLEng.com

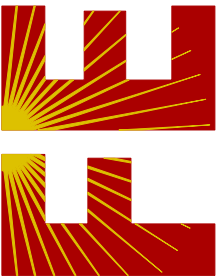

CA CERT. #30782

PROJECT NO. 2023126-17

TRACTOR:
TAYLOR MADE
EXTRUSIONS, INC.

MASTER PLAN

DESIGN DATE: 05/01/2025

REVISION 1: DATE

| | | |
|-------------|------|------|
| REVISION 2: | DATE | PAGE |
|-------------|------|------|

DRAWN BY: KHV 11

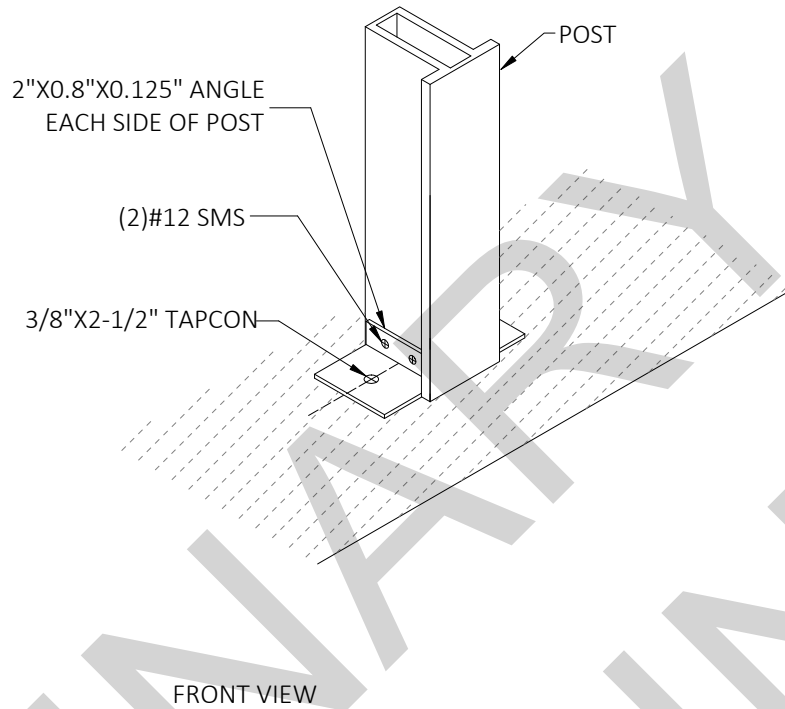
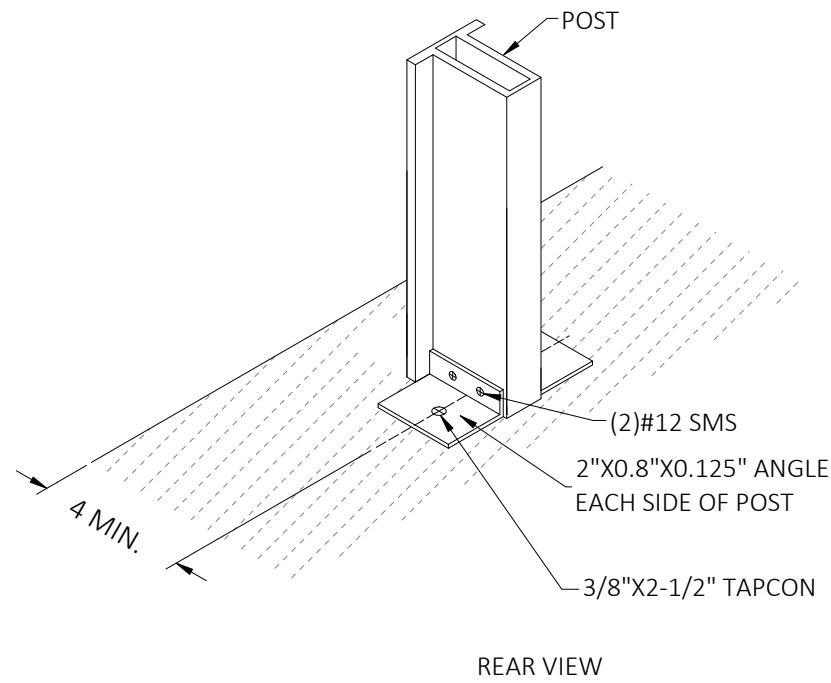

BEFORE INSTALLATION OF PERIMETER CHANNEL

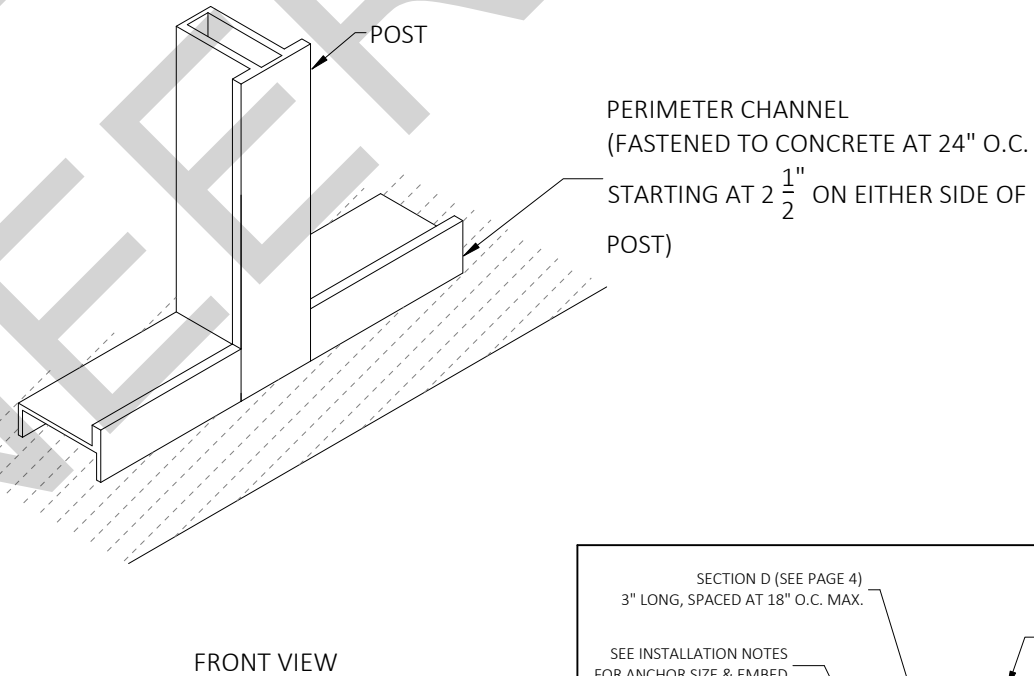
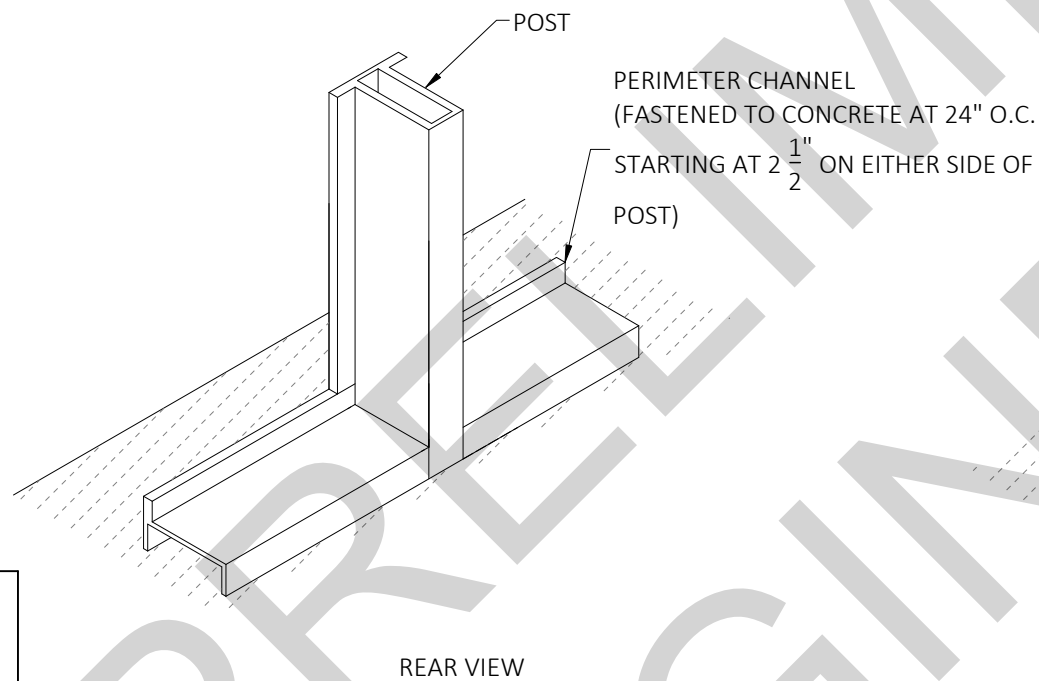

AFTER INSTALLATION OF PERIMETER CHANNEL

- INSTALLATION NOTES:
1. FASTEN PERIMETER CHANNEL TO MASONRY W/ 1/4" X 2-1/4" QUICKSET 24" O/C AND WITHIN 6" OF INTERSECTING MEMBERS AND JOINTS.
 2. FASTEN PERIMETER CHANNEL TO WOOD W/ 1/4"X 2-1/2" GALV. LAG BOLTS 24" O/C AND WITHIN 6" OF INTERSECTING MEMBERS AND JOINTS.

POST BASE CONNECTION DETAIL
(NON-EPOXY ANCHORS)
SCALE : N.T.S

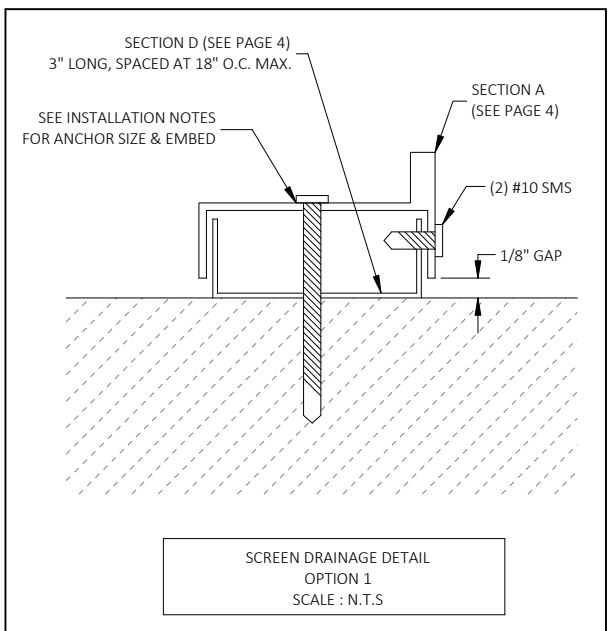

SCREEN DRAINAGE DETAIL
OPTION 1
SCALE : N.T.S

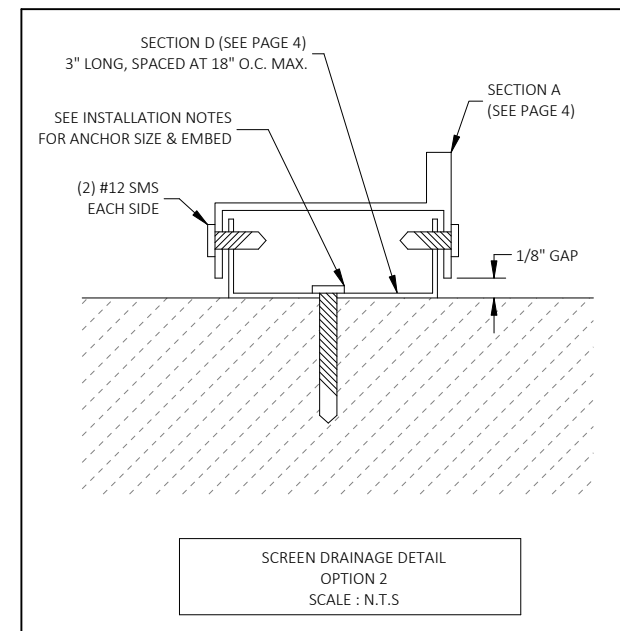

SCREEN DRAINAGE DETAIL
OPTION 2
SCALE : N.T.S

FLORIDA ENGINEERING LLC 4161
TAMIAMI TRAIL, UNIT 101
PORT CHARLOTTE, FLORIDA 33952
(941) 391-5980
www.FLEng.com

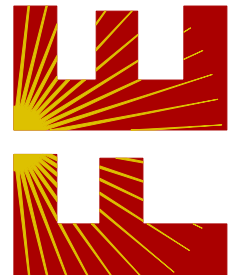

PROJECT NO. 2023126-17

CA CERT. #30782

CONTRACTOR:
TAYLOR MADE
EXTRUSIONS, INC.

PROJECT DESCRIPTION:
MASTER PLAN

DESIGN DATE: 05/01/2025

REVISION 1: DATE

REVISION 2: DATE

DRAWN BY: KHV

SCALE: NTS

PAGE :

2A

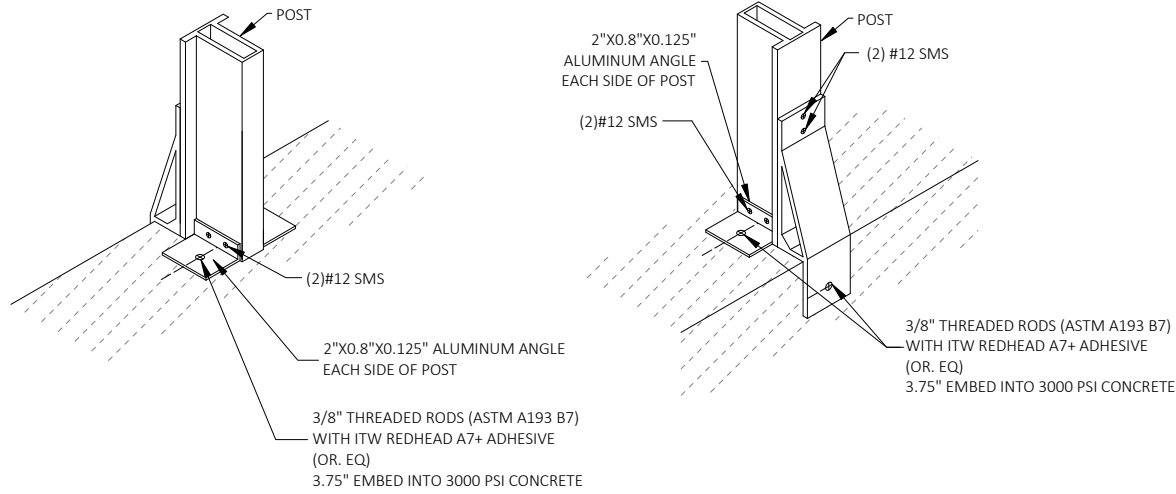

REAR VIEW

FRONT VIEW

BEFORE INSTALLATION OF PERIMETER CHANNEL

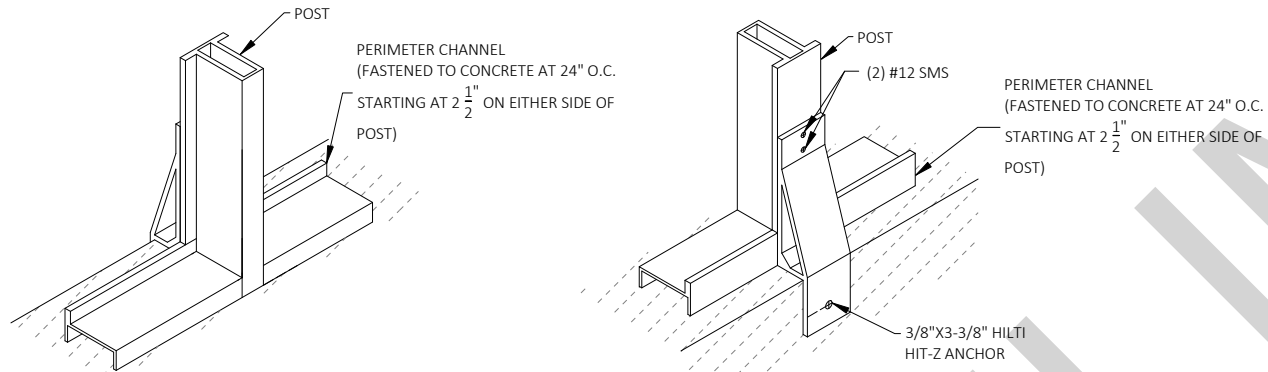

REAR VIEW

FRONT VIEW

AFTER INSTALLATION OF PERIMETER CHANNEL

INSTALLATION NOTES:

1. FASTEN PERIMETER CHANNEL TO ALUM EAVE RAIL W/ #12 X 1-1/2" SM 24" O/C AND WITHIN 6" OF INTERSECTING MEMBERS AND JOINTS.
2. FASTEN PERIMETER CHANNEL TO MASONRY W/ 1/4" X 2-1/4" QUICKSET 24" O/C AND WITHIN 6" OF INTERSECTING MEMBERS AND JOINTS.
3. FASTEN PERIMETER CHANNEL TO WOOD W/ 1/4"X 2-1/2" GALV. LAG BOLTS 24" O/C AND WITHIN 6" OF INTERSECTING MEMBERS AND JOINTS.

POST BASE CONNECTION DETAIL OPTION 1
(EPOXY ANCHORS)
SCALE : N.T.S

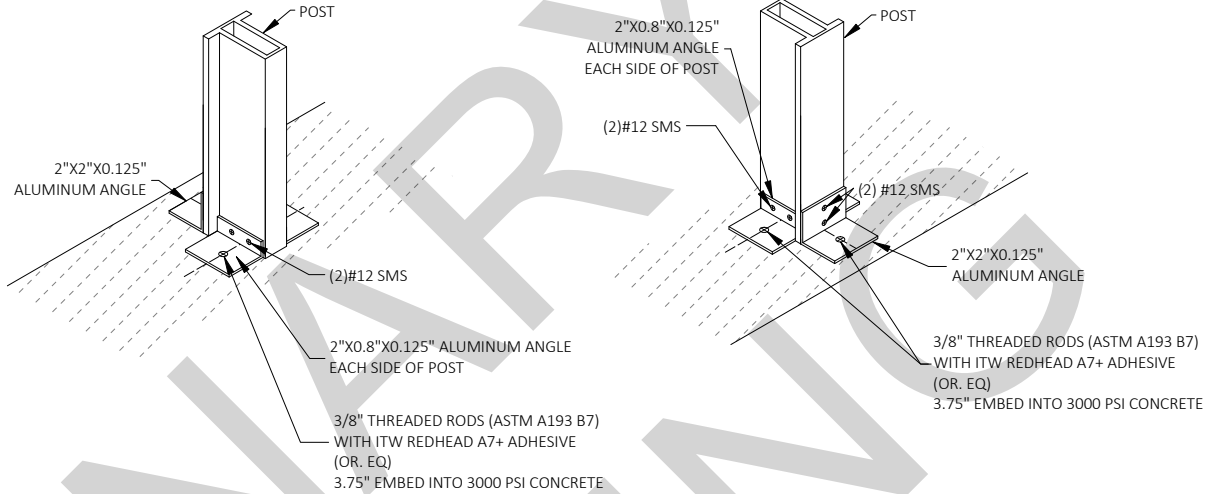

REAR VIEW

FRONT VIEW

BEFORE INSTALLATION OF PERIMETER CHANNEL

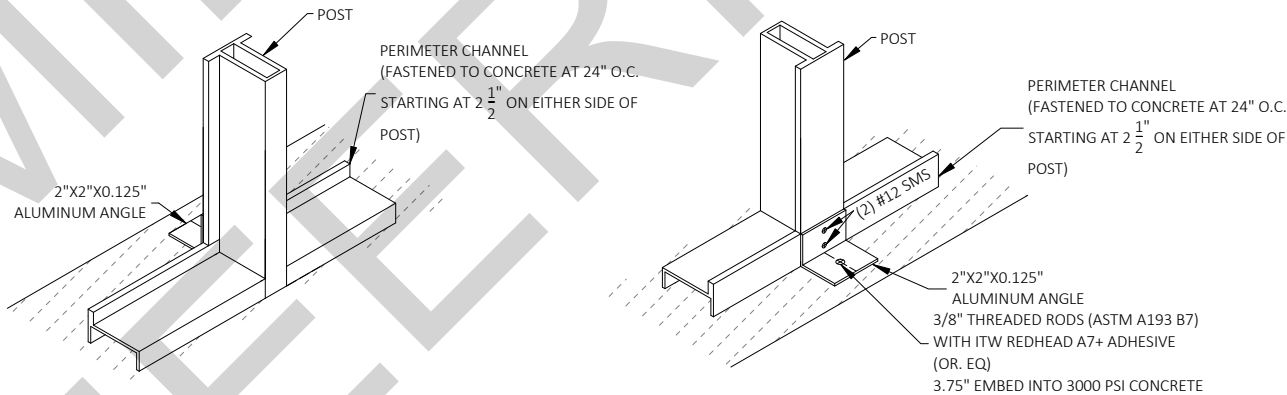

REAR VIEW

FRONT VIEW

AFTER INSTALLATION OF PERIMETER CHANNEL

INSTALLATION NOTES:

1. FASTEN PERIMETER CHANNEL TO MASONRY W/ 1/4" X 2-1/4" QUICKSET 24" O/C AND WITHIN 6" OF INTERSECTING MEMBERS AND JOINTS.
2. FASTEN PERIMETER CHANNEL TO WOOD W/ 1/4"X 2-1/2" GALV. LAG BOLTS 24" O/C AND WITHIN 6" OF INTERSECTING MEMBERS AND JOINTS.

POST BASE CONNECTION DETAIL OPTION 2
(EPOXY ANCHORS)
SCALE : N.T.S

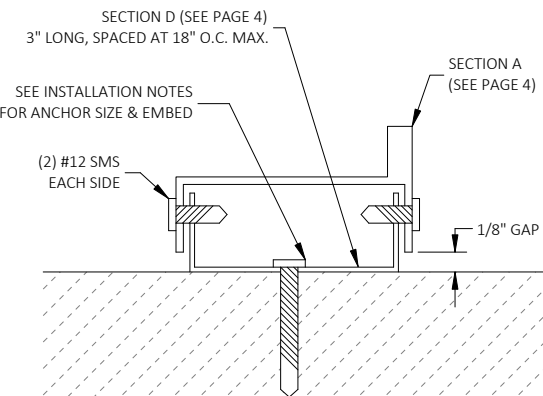

SCREEN DRAINAGE DETAIL
OPTION 2
SCALE : N.T.S

FLORIDA ENGINEERING LLC 4161
TAMIAMI TRAIL, UNIT 101
PORT CHARLOTTE, FLORIDA 33952
(941) 391-5980
www.FLEng.com



PROJECT NO. 2023126-17

CA CERT. #30782

CONTRACTOR:
TAYLOR MADE
EXTRUSIONS, INC.

PROJECT DESCRIPTION:
MASTER PLAN

DESIGN DATE: 05/01/2025

REVISION 1: DATE

REVISION 2: DATE

DRAWN BY: KHV

SCALE: NTS

PAGE :

2B

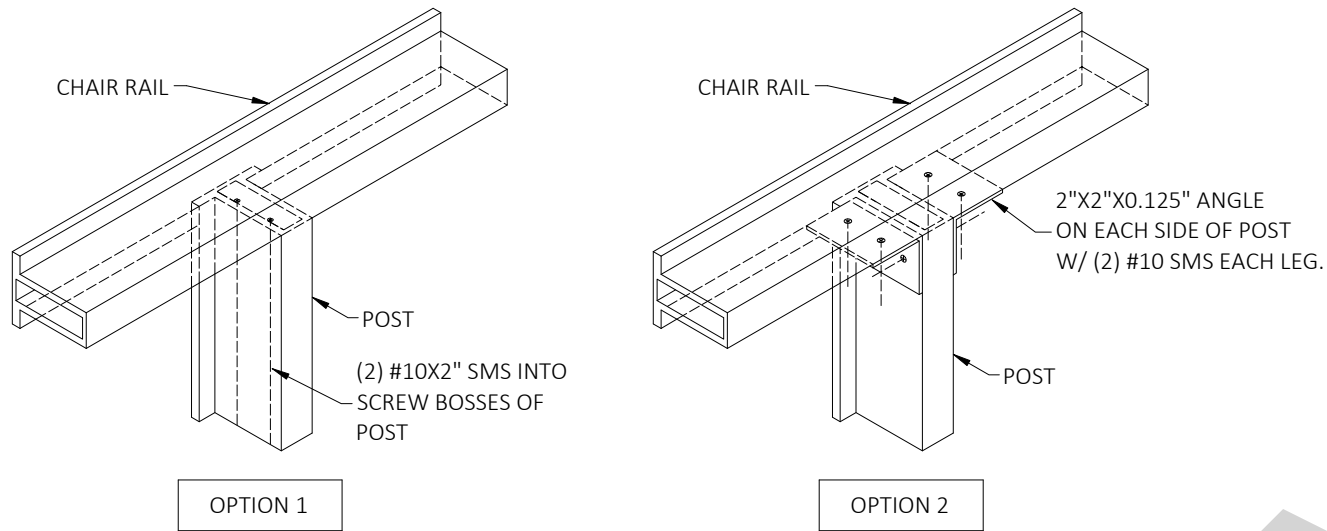

CHAIR RAIL TO POST
FASTENING DETAILS
SCALE : N.T.S

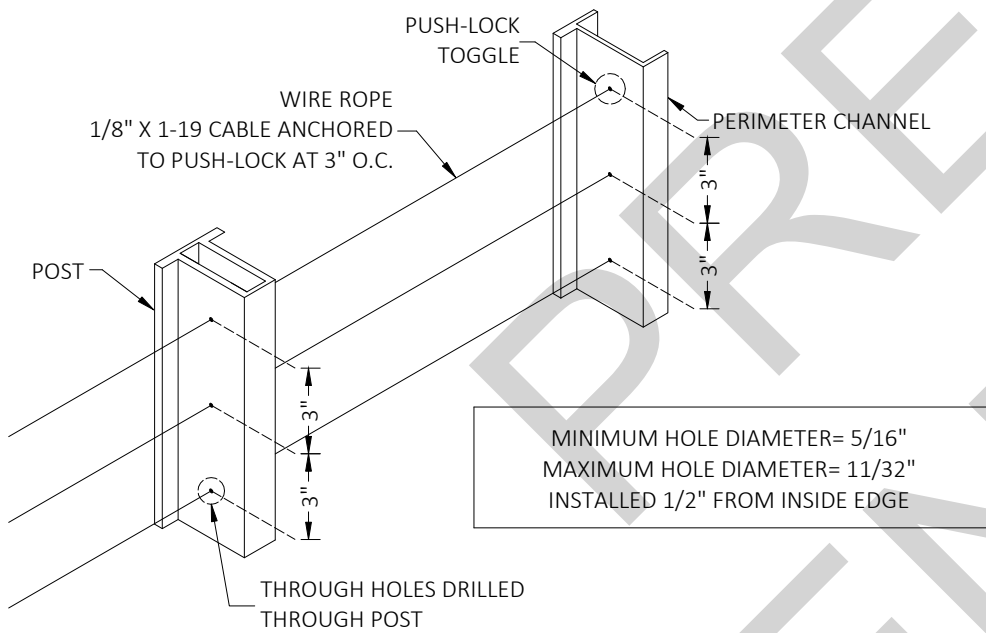

CABLE CONNECTION DETAIL
SCALE : N.T.S

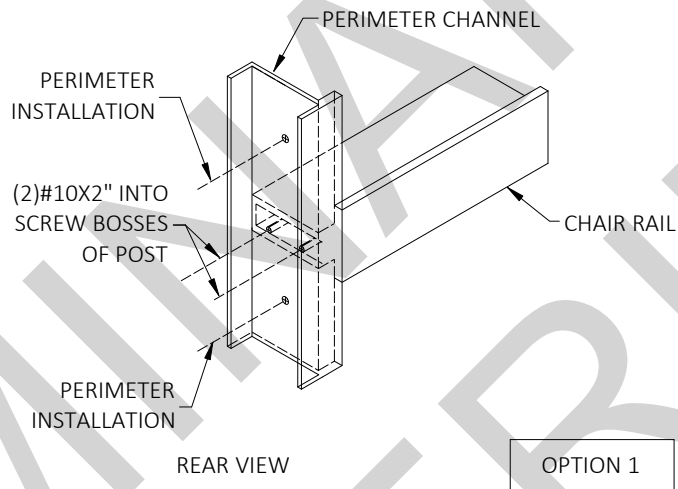

OPTION 1

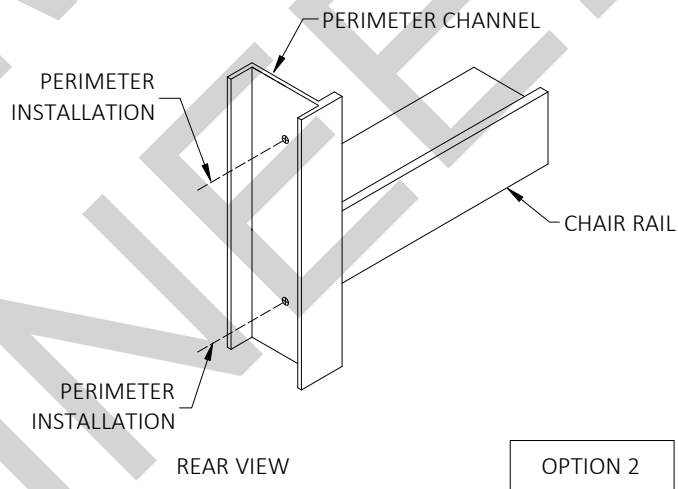

OPTION 2

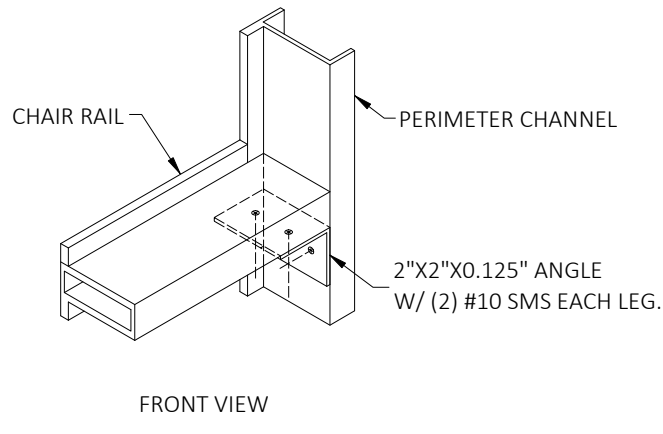
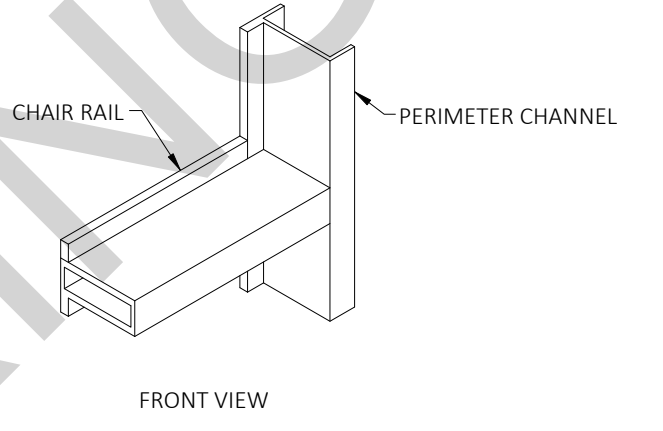

INSTALLATION NOTES:

1. FASTEN PERIMETER CHANNEL TO ALUM EAVE RAIL W/ #12 X 1-1/2" SMS 24" O/C AND WITHIN 6" OF INTERSECTING MEMBERS AND JOINTS.
2. FASTEN PERIMETER CHANNEL TO MASONRY W/ 1/4" X 2-1/4" QUICKSET 24" O/C AND WITHIN 6" OF INTERSECTING MEMBERS AND JOINTS.
3. FASTEN PERIMETER CHANNEL TO WOOD W/ 1/4" X 2-1/2" GALV. LAG BOLTS 24" O/C AND WITHIN 6" OF INTERSECTING MEMBERS AND JOINTS.

CHAIR RAIL & PERIMETER
FASTENING DETAILS
SCALE : N.T.S

FLORIDA ENGINEERING LLC 4161
TAMIAMI TRAIL, UNIT 101
PORT CHARLOTTE, FLORIDA 33952
(941) 391-5980
www.FLEng.com

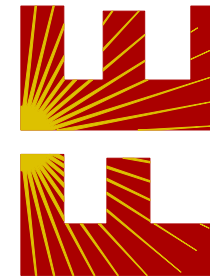

CONTRACTOR:
TAYLOR MADE
EXTRUSIONS, INC.

PROJECT DESCRIPTION:
MASTER PLAN

DESIGN DATE: 05/01/2025

REVISION 1: DATE

REVISION 2: DATE

DRAWN BY: KHV

SCALE: NTS

PAGE :

3A

PROJECT NO. 2023126-17

CA CERT. #30782

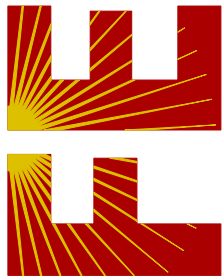
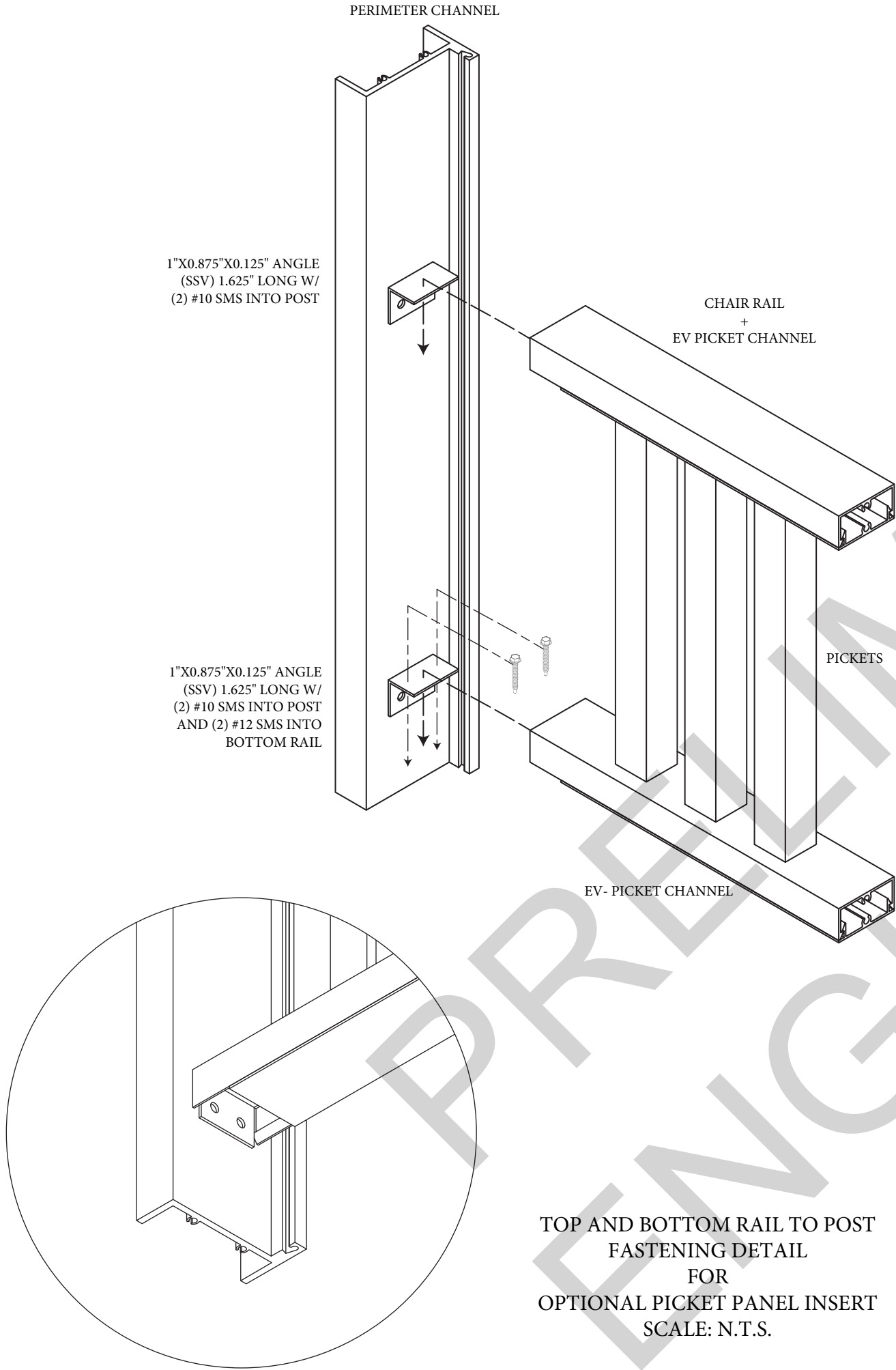

FLORIDA ENGINEERING LLC 4161
TAMIAMI TRAIL, UNIT 101
PORT CHARLOTTE, FLORIDA 33952
(941) 391-5980
www.FLEng.com

CONTRACTOR:
TAYLOR MADE
EXTRUSIONS, INC.

PROJECT DESCRIPTION:
MASTER PLAN

DESIGN DATE: 05/01/2025

REVISION 1: DATE

REVISION 2: DATE

DRAWN BY: KHV

SCALE: NTS

PAGE :

3B

PROJECT NO. 2023126-17

CA CERT. #30782

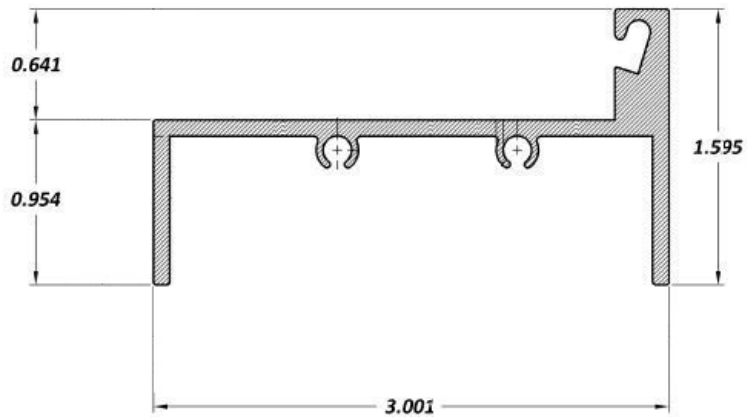

SECTION A
EV-TRACK CHANNEL

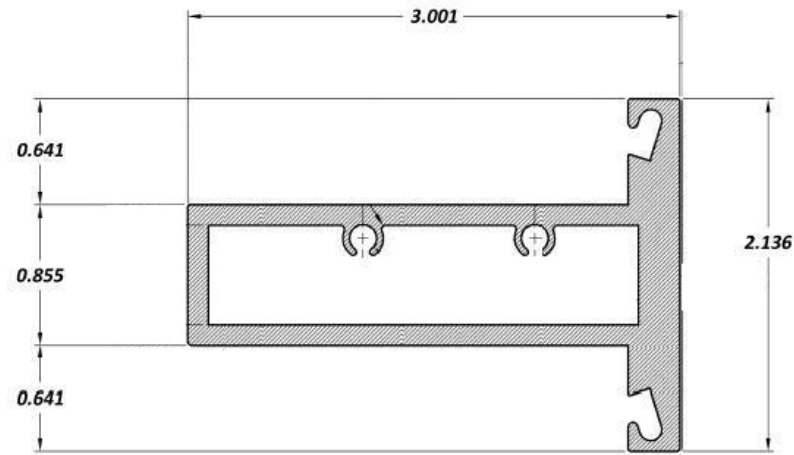

SECTION B
EV-CHAIR RAIL

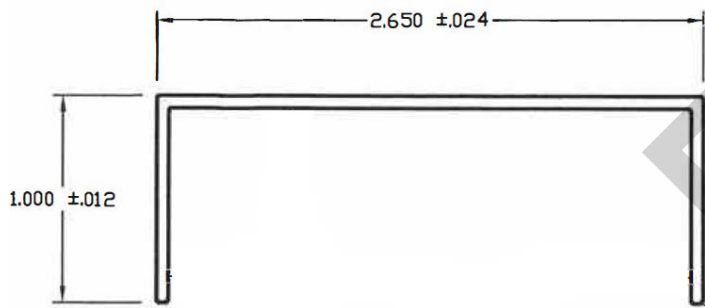

SECTION D
EV-DRAINAGE RC

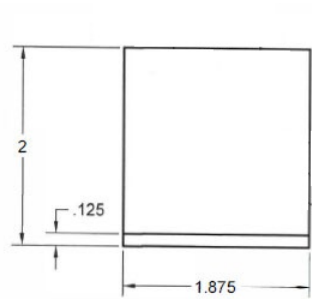

EV-4 HOLE CLIP

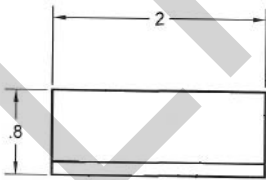

EV-3 HOLE CLIP

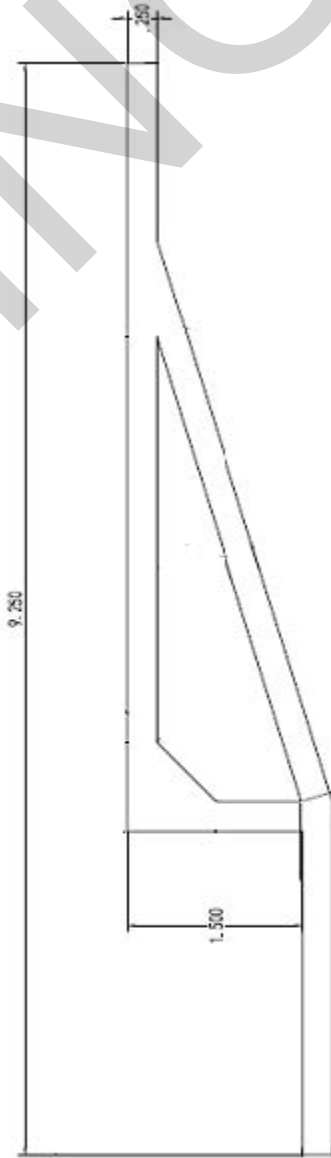
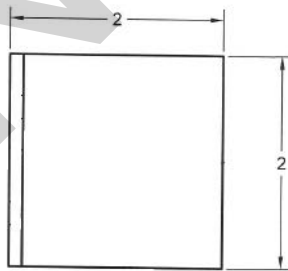
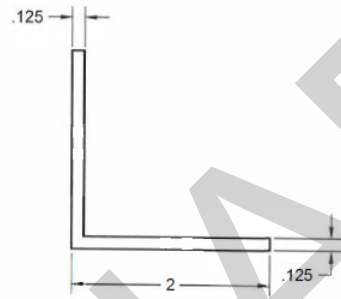
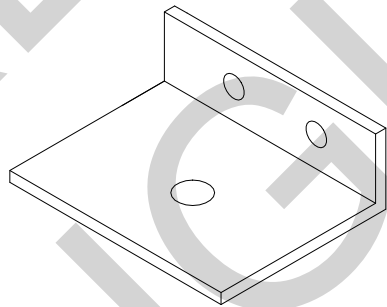

EV-Z BRACKET

FLORIDA ENGINEERING LLC 4161
TAMIAMI TRAIL, UNIT 101
PORT CHARLOTTE, FLORIDA 33952
(941) 391-5980
www.FLEng.com

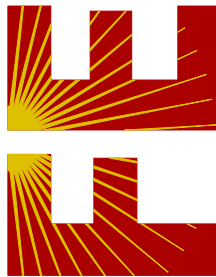

PROJECT NO. 2023126-17

CA CERT. #30782

CONTRACTOR:
TAYLOR MADE
EXTRUSIONS, INC.

PROJECT DESCRIPTION:
MASTER PLAN

DESIGN DATE: 05/01/2025

REVISION 1: DATE

REVISION 2: DATE

DRAWN BY: KHV

SCALE: NTS

PAGE :

4A

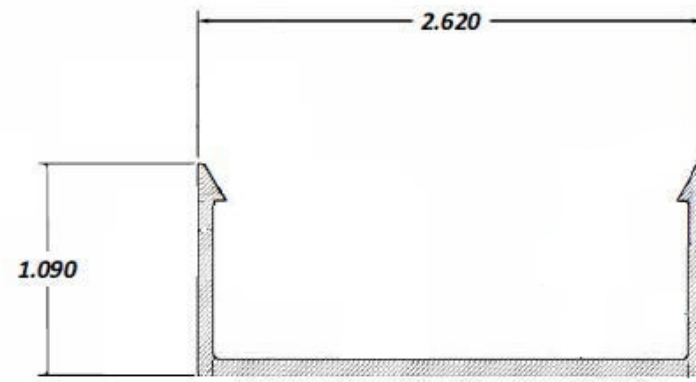

EV - PICKET CHANNEL



SECTION C
EV - PICKET SNAP PLATE

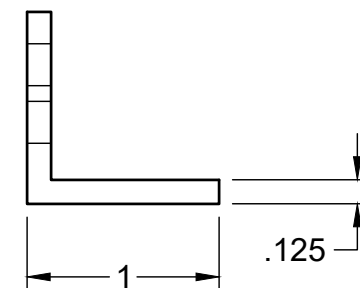
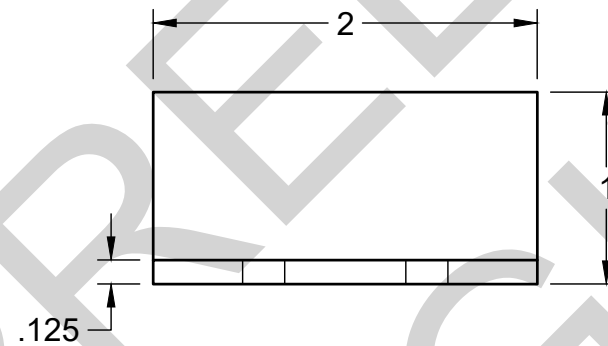

EV - 4 HOLE PICKET CLIP

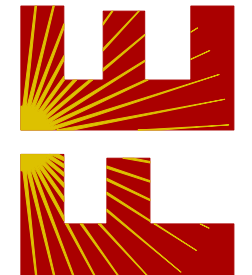
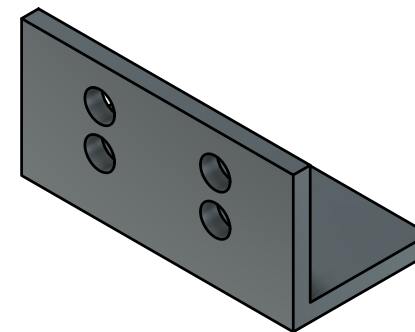

FLORIDA ENGINEERING LLC 4161
TAMIAMI TRAIL, UNIT 101
PORT CHARLOTTE, FLORIDA 33952
(941) 391-5980
www.FLEng.com

CONTRACTOR:
TAYLOR MADE
EXTRUSIONS, INC.

PROJECT DESCRIPTION:
MASTER PLAN

DESIGN DATE: 05/01/2025

REVISION 1: DATE

REVISION 2: DATE

DRAWN BY: KHV

SCALE: NTS

PROJECT NO. 2023126-17

CA CERT. #30782