

APPLICABLE CODES, REGULATIONS & STANDARDS

1. 2023 FLORIDA BUILDING CODE, BUILDING (8TH EDITION)
2. 2023 FLORIDA BUILDING CODE, RESIDENTIAL (8TH EDITION)
3. ASCE 7-22: MINIMUM DESIGN LOADS ON BUILDINGS AND OTHER STRUCTURES
4. ACI 318-19: BUILDING CODE REQUIREMENTS FOR STRUCTURAL CONCRETE
6. 2020 ALUMINUM DESIGN MANUAL

WIND LOADS (SEC 1609)

1. RISK CATEGORY = II
2. BASIC WIND SPEED = 160 MPH
3. EXPOSURE CATEGORY = D

LIVE LOADS FOR NON-RESIDENTIAL STRUCTURES (SEC 1607.8)

1. GUARDRAILS AND HANDRAILS
 - A. LINEAR LOAD OF 50 PLF
 - B. CONCENTRATED LOAD OF 200 LBF
2. INTERMEDIATE RAILS
CONCENTRATED LOAD OF 50 LBF

LIVE LOADS FOR RESIDENTIAL STRUCTURES (TABLE R301.5)

- GUARDS AND HANDRAILS = 200 PSF
GUARD IN-FILL COMPONENTS = 50 PSF

GENERAL NOTES AND SPECIFICATIONS

1. THE STRUCTURES INDICATED HEREIN ARE DESIGNED TO BE INSTALLED WITHIN MASONRY OR WOOD FRAME HOST STRUCTURES OF ADEQUATE STRUCTURAL CAPACITY. THE CONTRACTOR SHALL VERIFY THAT THE HOST STRUCTURE IS IN GOOD CONDITION AND OF SUFFICIENT STRENGTH TO SUPPORT THE PROPOSED ADDITION.
2. ALUMINUM EXTRUSIONS SHALL MEET THE STRENGTH REQUIREMENTS OF ASTM B221 AFTER POWDER COATING.
3. ALL ALUMINUM EXTRUSIONS ARE TO BE A MINIMUM 6063-T6.
4. SITE SPECIFIC ENGINEERING REQUIRED FOR ALL INSTALLATIONS ABOVE AN ELEVATION OF 60 FT FROM GRADE.
5. THE SCHEMATIC SHOWN ON PAGE 1 AS WELL AS THE DETAILS ON THE FOLLOWING PAGES ARE DESIGNED BASED ON THE PROVISIONS OF THE BUILDING CODE.
6. CABLES TO BE ATTACHED TO FRAME MEMBERS USING PUSH-LOCK TOGGLE TENSIONER ON ONE SIDE AND PUSH-LOCK TOGGER NON-TENSIONER ON THE OTHER SIDE, WITH A WORKING LOAD RATING OF 750 LBF, BY TAYLOR MADE EXTRUSIONS, INCORPORATED. SEE MANUFACTURER'S SPECIFICATIONS FOR DETAILS.

TABLE A - FOR TOTAL WIDTH <= 16'-0"

(TO BE USED FOR INSTALLATIONS WITH NON-EPOXY ANCHORS, SEE PAGE 2A)

NUMBER OF PANELS	MAXIMUM PANEL WIDTH	DISTANCE BETWEEN FULL-LENGTH POSTS
1	5'-6"	5'-6"
2	5'-1"	10'-2"
3	4'-8"	14'-0"
4	4'-0"	16'-0"

TABLE B - FOR TOTAL WIDTH >= 16'-0"

(TO BE USED FOR INSTALLATIONS WITH EPOXY ANCHORS, SEE PAGE 2B)

NUMBER OF PANELS	MAXIMUM PANEL WIDTH	DISTANCE BETWEEN FULL-LENGTH POSTS
3	5'-4"	16'-0"
4	5'-3"	21'-0"

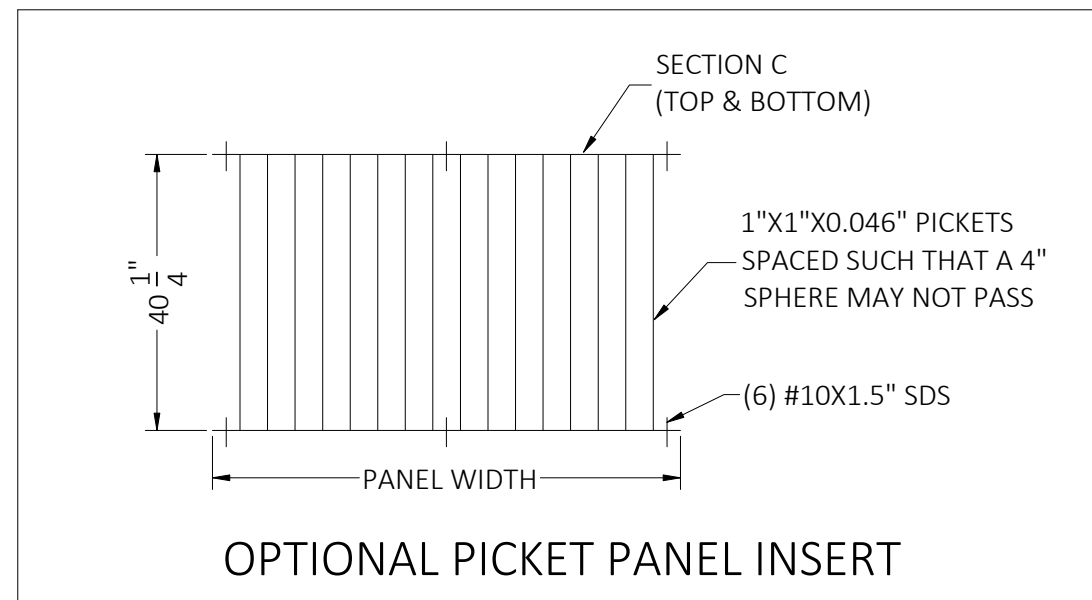

THE APPLICABILITY OF THIS DESIGN FOR ANY SITE-SPECIFIC PROJECT REQUIRES THE SIGN & SEAL OF A PROFESSIONAL ENGINEER.

MEMBER LEGEND

NO.	MEMBER	SECTION LABEL
1	PERIMETER CHANNEL	SECTION A
2	FULL-LENGTH POST	SECTION B
3	RAILING TOP CAP	SECTION B
4	INTERMEDIATE POST	SECTION B
5	WIRE ROPE	1/8" X 1-19 CABLE (316 S.S.)

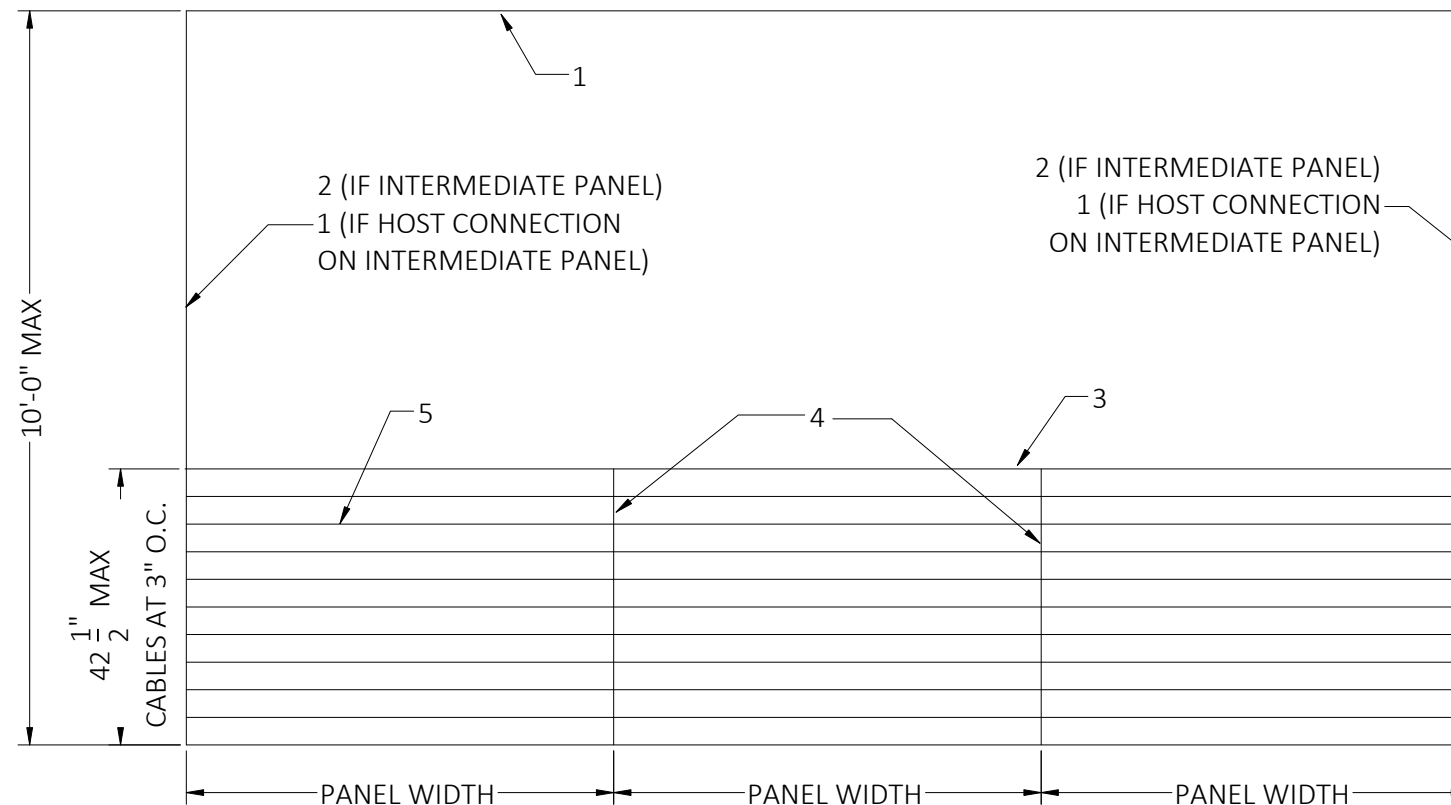

TYPICAL PANEL LAYOUT

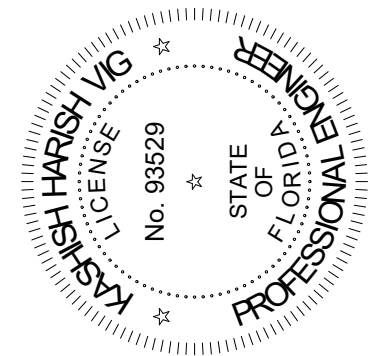

Kashish Harish Vig, P.E. #93529
DATE:

FLORIDA ENGINEERING LLC 4161
TAMIAMI TRAIL, UNIT 101
PORT CHARLOTTE, FLORIDA 33952
(941) 391-5980
www.FLEng.com

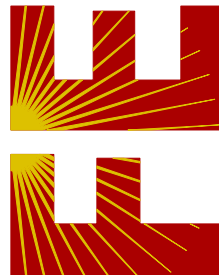

CA CERT. #30782

PROJECT NO. 2023126-16

CONTRACTOR:
TAYLOR MADE
EXTRUSIONS, INC.

PROJECT DESCRIPTION:
MASTER PLAN

DESIGN DATE: 02/12/2024

REVISION 1: DATE

REVISION 2: DATE

DRAWN BY: KHV

SCALE: NTS

PAGE:
1A

TABLE A - FOR TOTAL WIDTH ≤ 12'-0"
(TO BE USED FOR INSTALLATIONS WITH NON-EPOXY ANCHORS, SEE PAGE 2A)

NUMBER OF PANELS	MAXIMUM PANEL WIDTH	DISTANCE BETWEEN FULL-LENGTH POSTS
2	6'-0"	12'-0"

MEMBER LEGEND

NO.	MEMBER	SECTION SIZE
1	PERIMETER CHANNEL	SECTION A
2	FULL-LENGTH POST	SECTION B
3	RAILING TOP CAP	SECTION B
4	INTERMEDIATE POST	SECTION B
5	WIRE ROPE	1/8" X 1-19 CABLE (316 S.S.)
6	FLAT BAR	1" X 1/4"

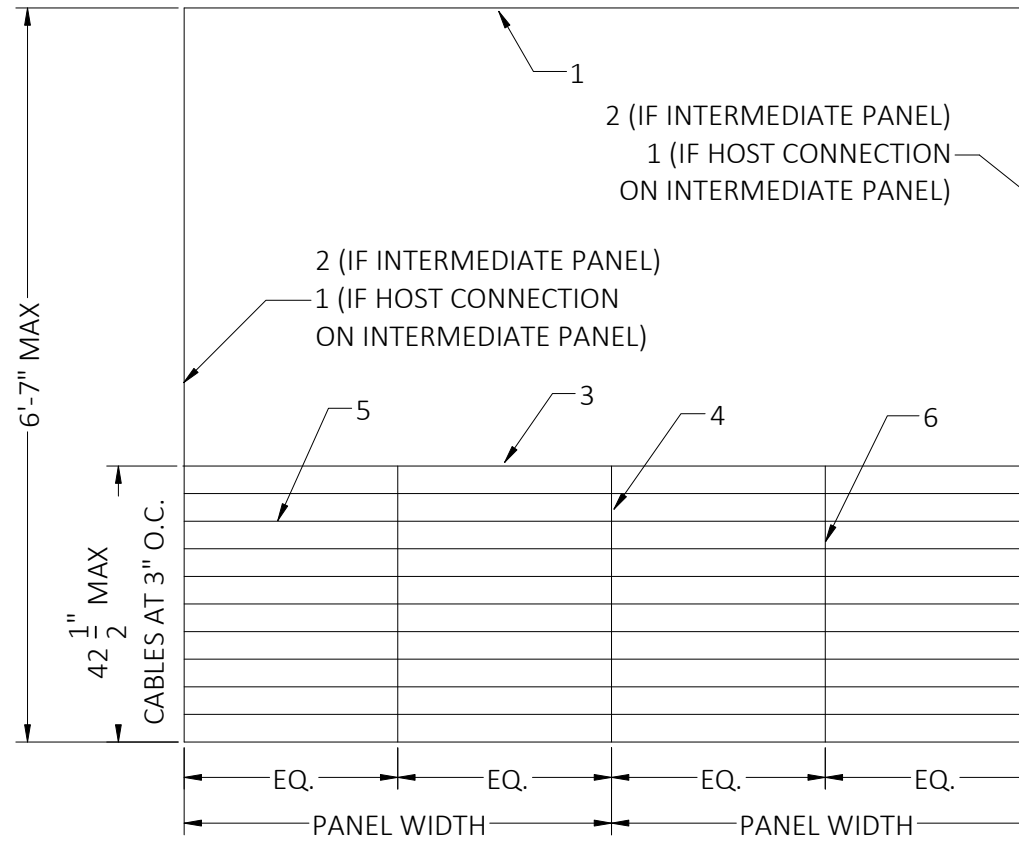

TYPICAL PANEL LAYOUT

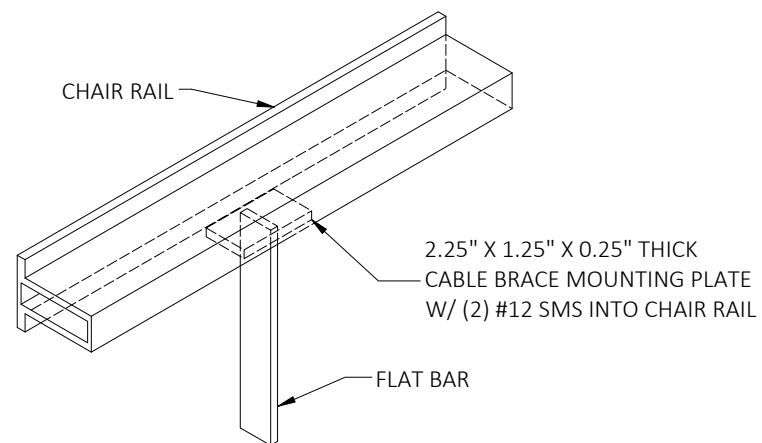
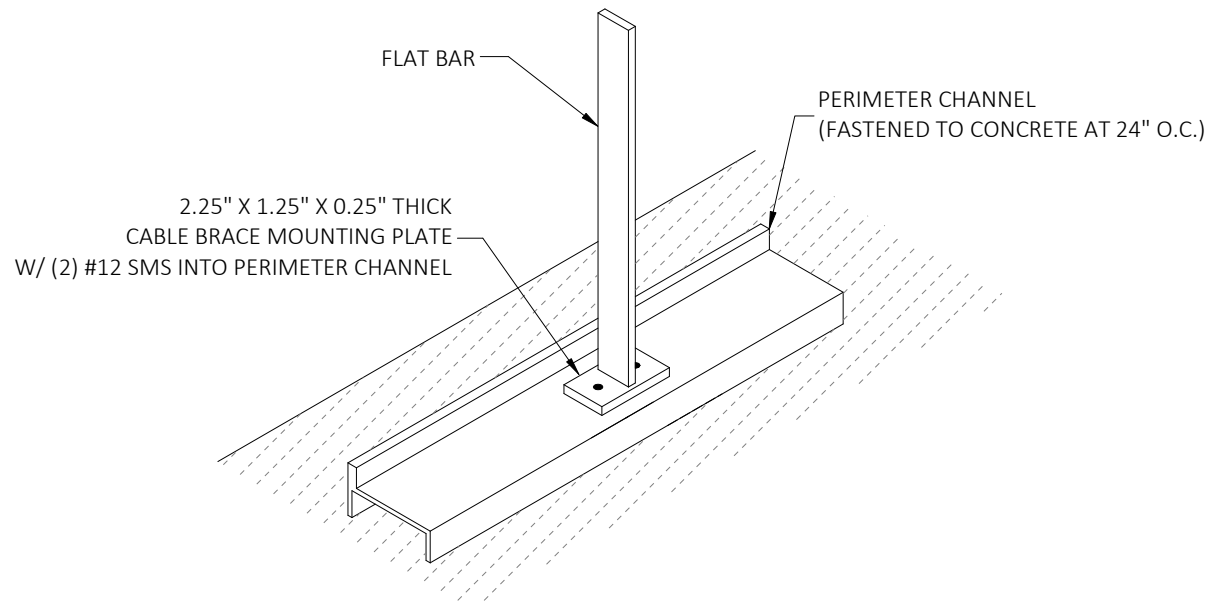

FLAT BAR
FASTENING DETAILS
SCALE : N.T.S

PANEL LAYOUT - (2) PANEL SPECIAL CASE

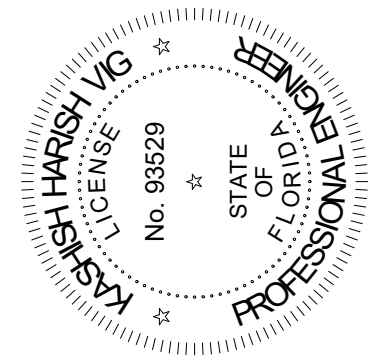

Kashish Harish Vig, P.E. #93529

DATE:

FLORIDA ENGINEERING LLC 4161
TAMIAMI TRAIL, UNIT 101
PORT CHARLOTTE, FLORIDA 33952
(941) 391-5980
www.FLEng.com

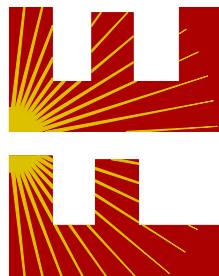

CA CERT. #30782

PROJECT NO. 2023126-16

CONTRACTOR:
TAYLOR MADE
EXTRUSIONS, INC.

PROJECT DESCRIPTION:
MASTER PLAN

DESIGN DATE: 02/12/2024

REVISION 1: DATE

REVISION 2: DATE

DRAWN BY: KHV

SCALE: NTS

PAGE :
1B

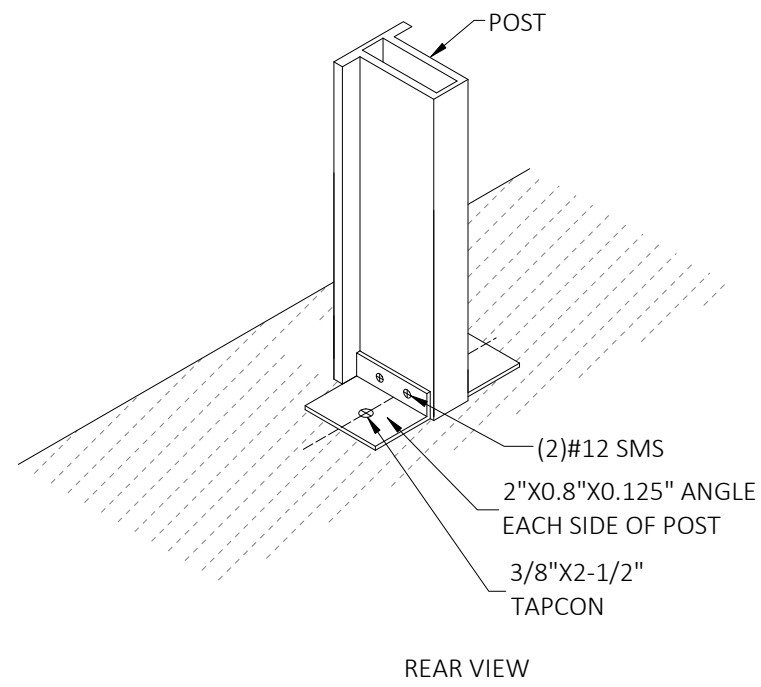

REAR VIEW

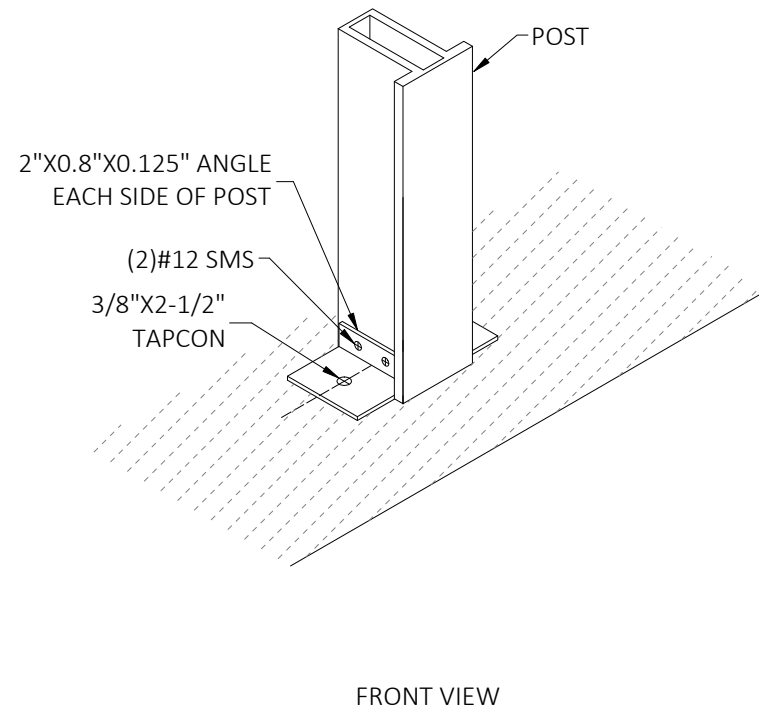

FRONT VIEW

BEFORE INSTALLATION OF PERIMETER CHANNEL

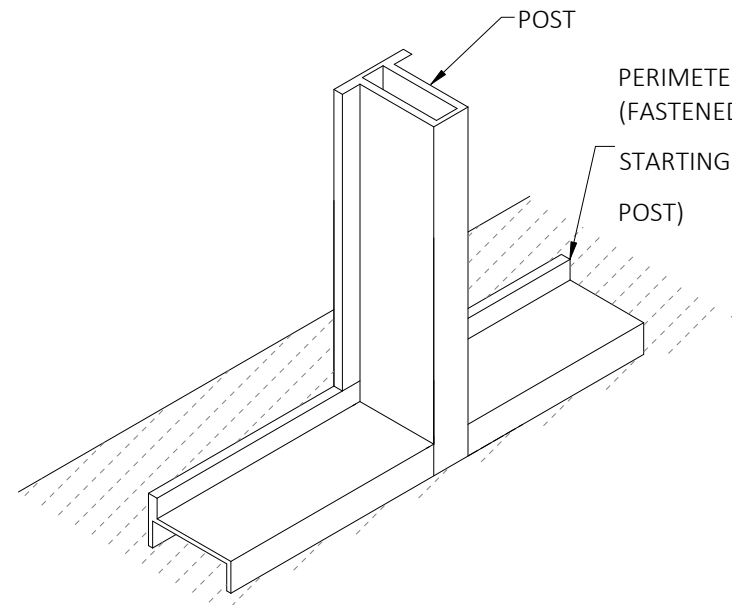

REAR VIEW

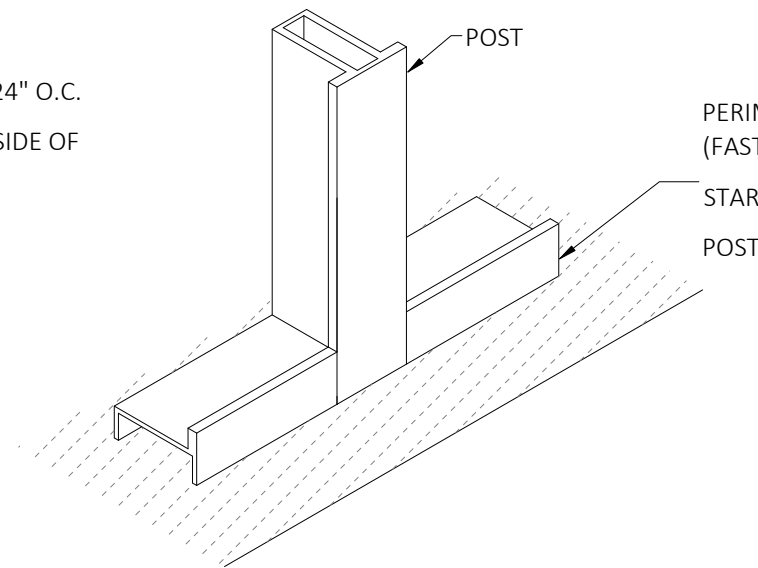

FRONT VIEW

AFTER INSTALLATION OF PERIMETER CHANNEL

INSTALLATION NOTES:

1. FASTEN PERIMETER CHANNEL TO MASONRY W/ 1/4" X 2-1/4" QUICKSET 24" O/C AND WITHIN 6" OF INTERSECTING MEMBERS AND JOINTS.
2. FASTEN PERIMETER CHANNEL TO WOOD W/ 1/4" X 2-1/2" GALV. LAG BOLTS 24" O/C AND WITHIN 6" OF INTERSECTING MEMBERS AND JOINTS.

POST BASE CONNECTION DETAIL
(NON-EPOXY ANCHORS)
SCALE : N.T.S

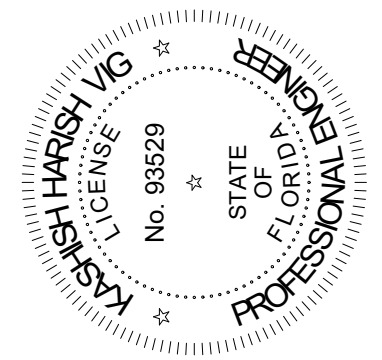

Kashish Harish Vig, P.E. #93529
DATE:

FLORIDA ENGINEERING LLC 4161
TAMIAMI TRAIL, UNIT 101
PORT CHARLOTTE, FLORIDA 33952
(941) 391-5980
www.FLEng.com

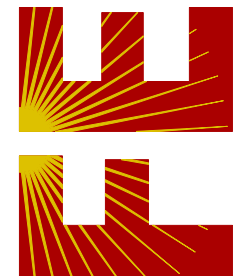

CA CERT. #30782

PROJECT NO. 2023126-16

CONTRACTOR:
TAYLOR MADE
EXTRUSIONS, INC.

PROJECT DESCRIPTION:
MASTER PLAN

DESIGN DATE:	02/12/2024
REVISION 1:	DATE
REVISION 2:	03/03/2021
DRAWN BY:	KHV
SCALE:	NTS

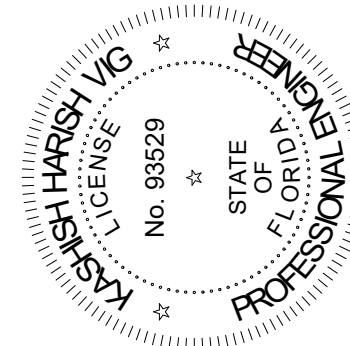

Kashish Harish Vig, P.E. #93529
DATE:

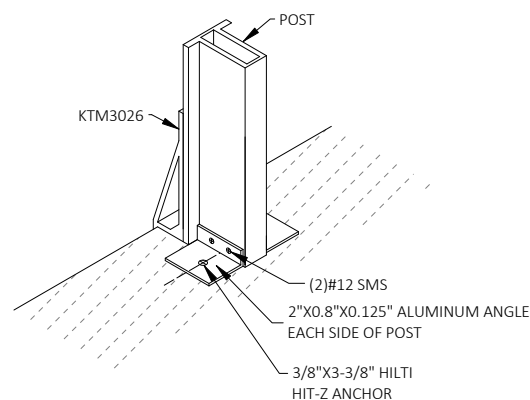

REAR VIEW

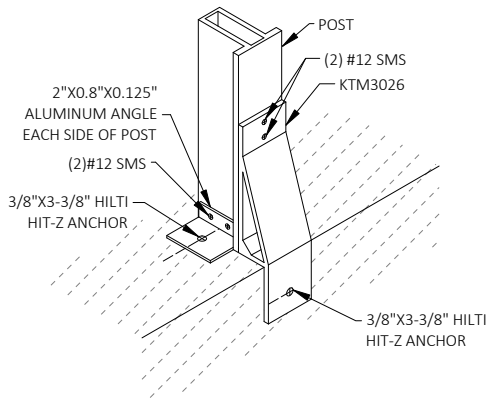

FRONT VIEW

BEFORE INSTALLATION OF PERIMETER CHANNEL

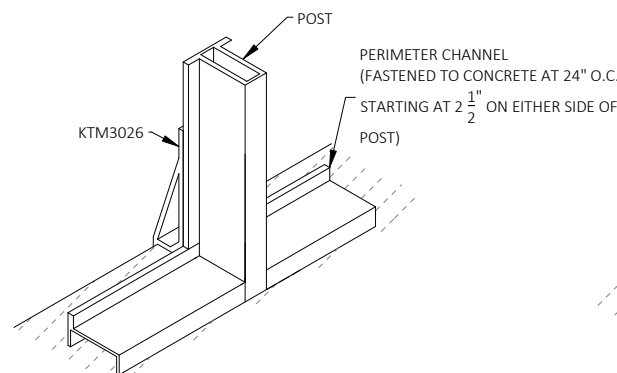

REAR VIEW

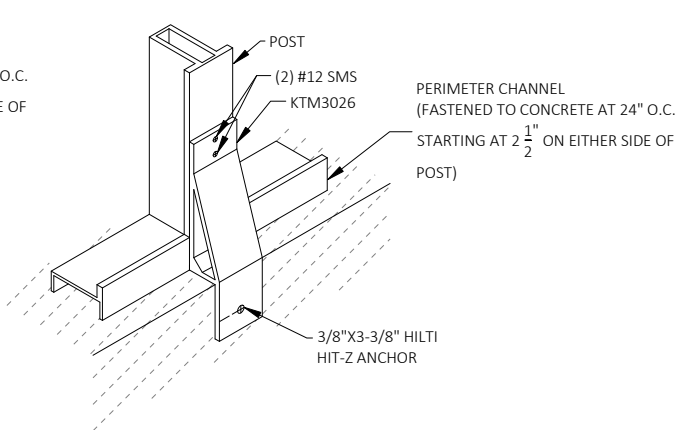

FRONT VIEW

AFTER INSTALLATION OF PERIMETER CHANNEL

INSTALLATION NOTES:

1. FASTEN PERIMETER CHANNEL TO ALUM EAVE RAIL W/ #12 X 1-1/2" SMS 24" O/C AND WITHIN 6" OF INTERSECTING MEMBERS AND JOINTS.
2. FASTEN PERIMETER CHANNEL TO MASONRY W/ 1/4" X 2-1/4" QUICKSET 24" O/C AND WITHIN 6" OF INTERSECTING MEMBERS AND JOINTS.
3. FASTEN PERIMETER CHANNEL TO WOOD W/ 1/4" X 2-1/2" GALV. LAG BOLTS 24" O/C AND WITHIN 6" OF INTERSECTING MEMBERS AND JOINTS.

POST BASE CONNECTION DETAIL OPTION 1
(EPOXY ANCHORS)
SCALE : N.T.S

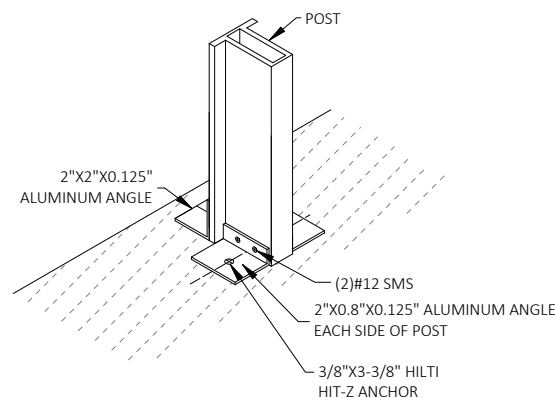

REAR VIEW

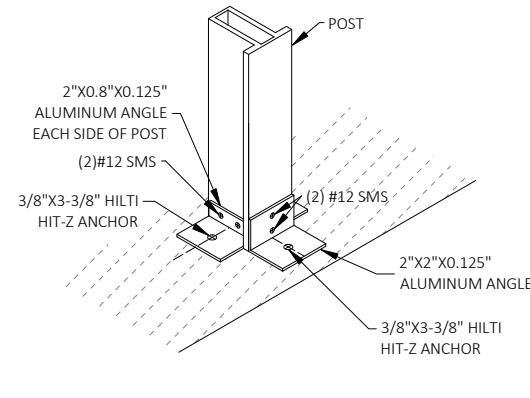

FRONT VIEW

BEFORE INSTALLATION OF PERIMETER CHANNEL

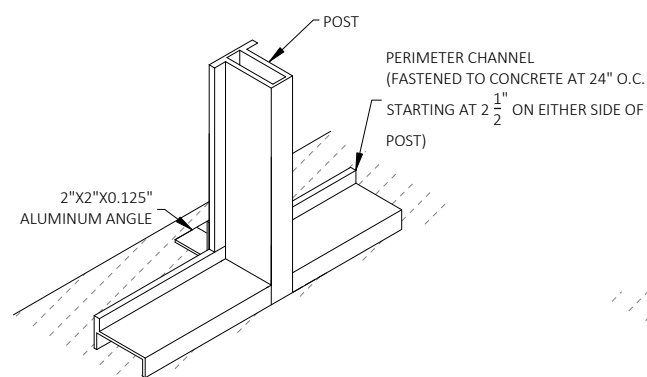

REAR VIEW

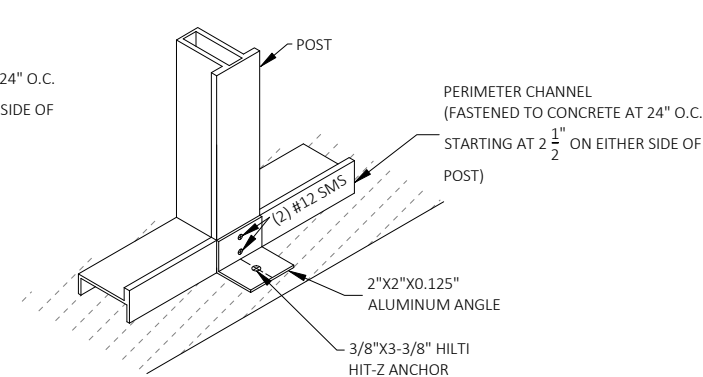

FRONT VIEW

AFTER INSTALLATION OF PERIMETER CHANNEL

INSTALLATION NOTES:

1. FASTEN PERIMETER CHANNEL TO MASONRY W/ 1/4" X 2-1/4" QUICKSET 24" O/C AND WITHIN 6" OF INTERSECTING MEMBERS AND JOINTS.
2. FASTEN PERIMETER CHANNEL TO WOOD W/ 1/4" X 2-1/2" GALV. LAG BOLTS 24" O/C AND WITHIN 6" OF INTERSECTING MEMBERS AND JOINTS.

POST BASE CONNECTION DETAIL OPTION 2
(EPOXY ANCHORS)
SCALE : N.T.S

FLORIDA ENGINEERING LLC 4161
TAMIAMI TRAIL, UNIT 101
PORT CHARLOTTE, FLORIDA 33952
(941) 391-5980
www.FLEng.com



CONTRACTOR:
TAYLOR MADE
EXTRUSIONS, INC.

PROJECT DESCRIPTION:
MASTER PLAN

DESIGN DATE: 02/12/2024

REVISION 1: DATE

REVISION 2: 03/03/2021

PAGE :

DRAWN BY: KHV

SCALE: NTS

2B

CA CERT. #30782

PROJECT NO. 2023126-16

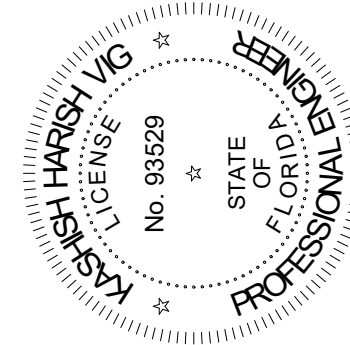

Kashish Harish Vig, P.E. #93529
DATE:

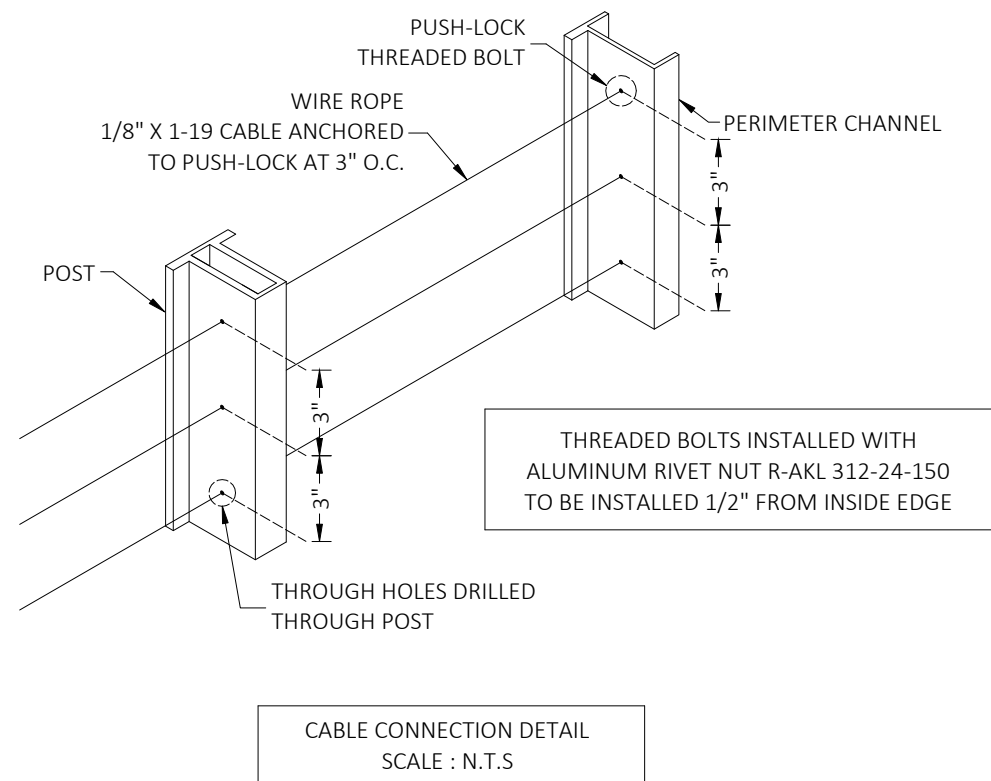
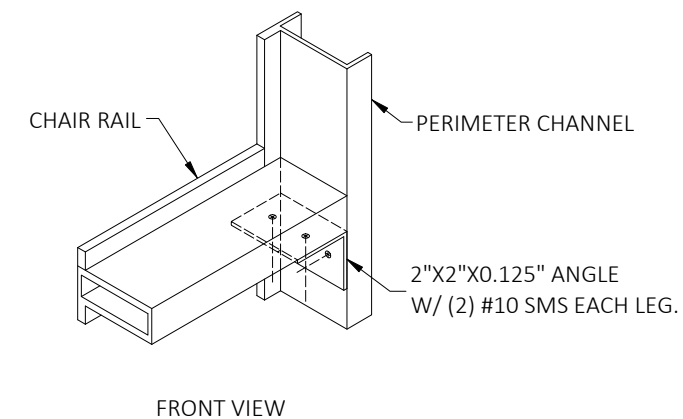
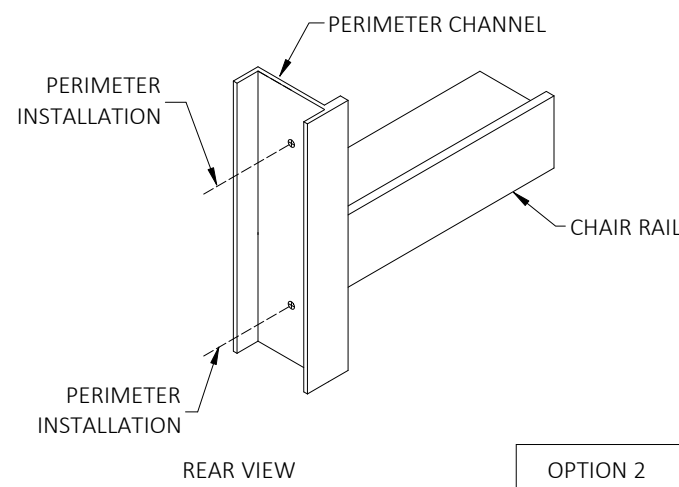
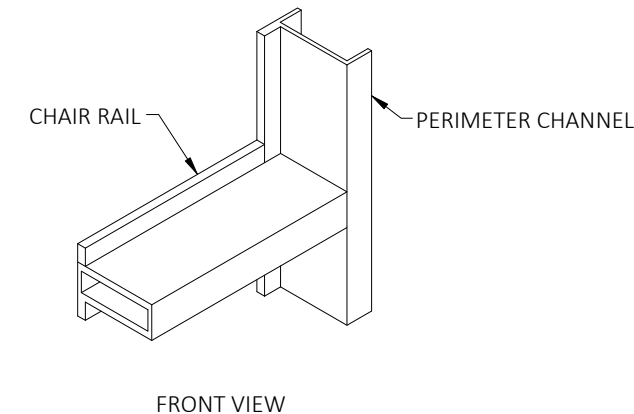
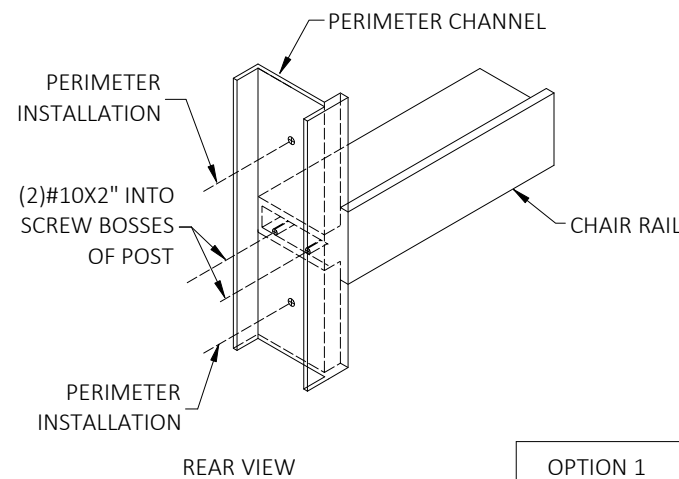
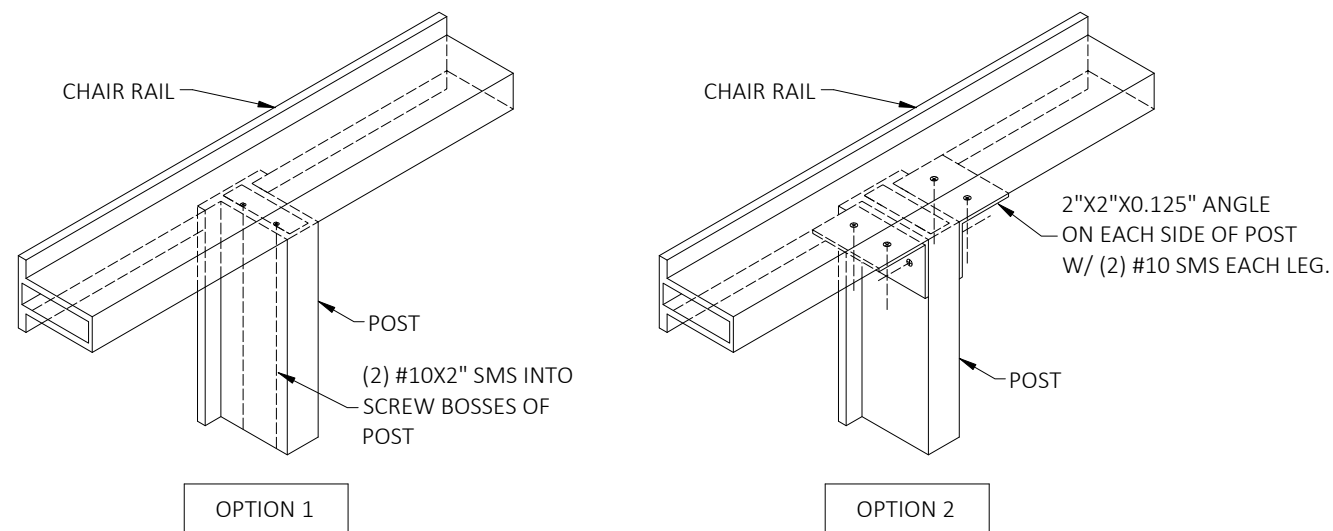

INSTALLATION NOTES:

1. FASTEN PERIMETER CHANNEL TO ALUM EAVE RAIL W/ #12 X 1-1/2" SMS 24" O/C AND WITHIN 6" OF INTERSECTING MEMBERS AND JOINTS.
2. FASTEN PERIMETER CHANNEL TO MASONRY W/ 1/4" X 2-1/4" QUICKSET 24" O/C AND WITHIN 6" OF INTERSECTING MEMBERS AND JOINTS.
3. FASTEN PERIMETER CHANNEL TO WOOD W/ 1/4" X 2-1/2" GALV. LAG BOLTS 24" O/C AND WITHIN 6" OF INTERSECTING MEMBERS AND JOINTS.

FLORIDA ENGINEERING LLC 4161
TAMIAMI TRAIL, UNIT 101
PORT CHARLOTTE, FLORIDA 33952
(941) 391-5980
www.FLEng.com



CONTRACTOR:
TAYLOR MADE EXTRUSIONS, INC.

PROJECT DESCRIPTION:
MASTER PLAN

DESIGN DATE: 02/12/2024

REVISION 1: DATE

REVISION 2: DATE PAGE :

DRAWN BY: KHV

SCALE: NTS

3

CA CERT. #30782

PROJECT NO. 2023126-16

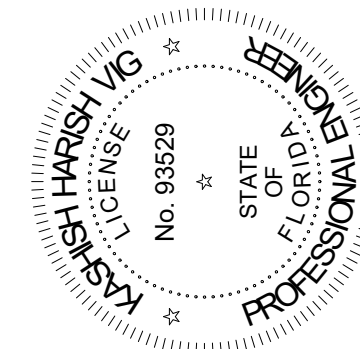

Kashish Harish Vig, P.E. #93529
DATE:

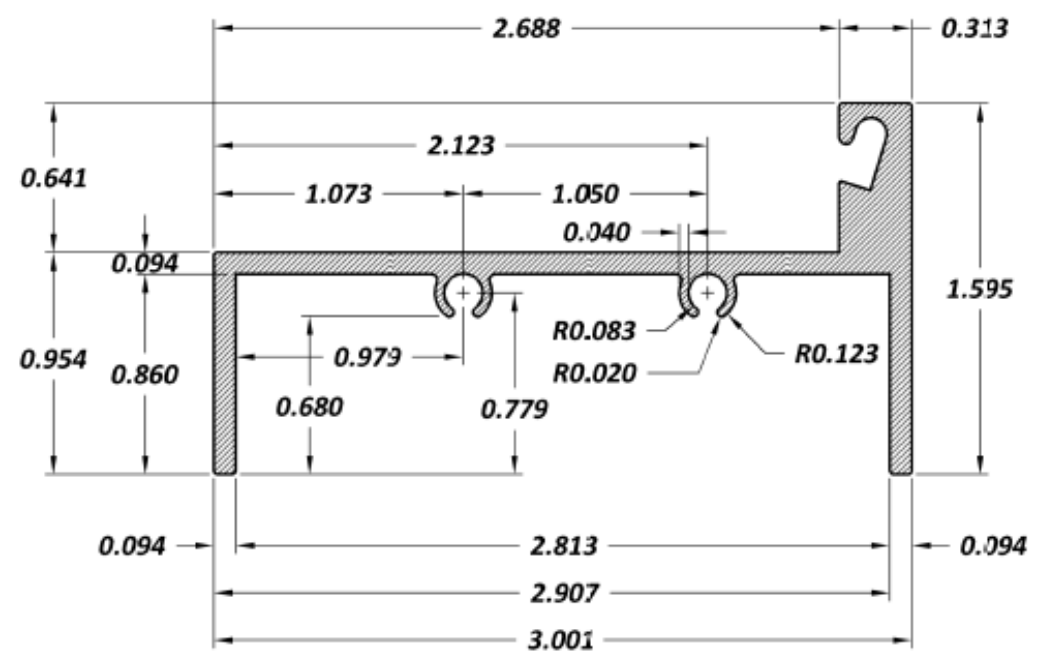
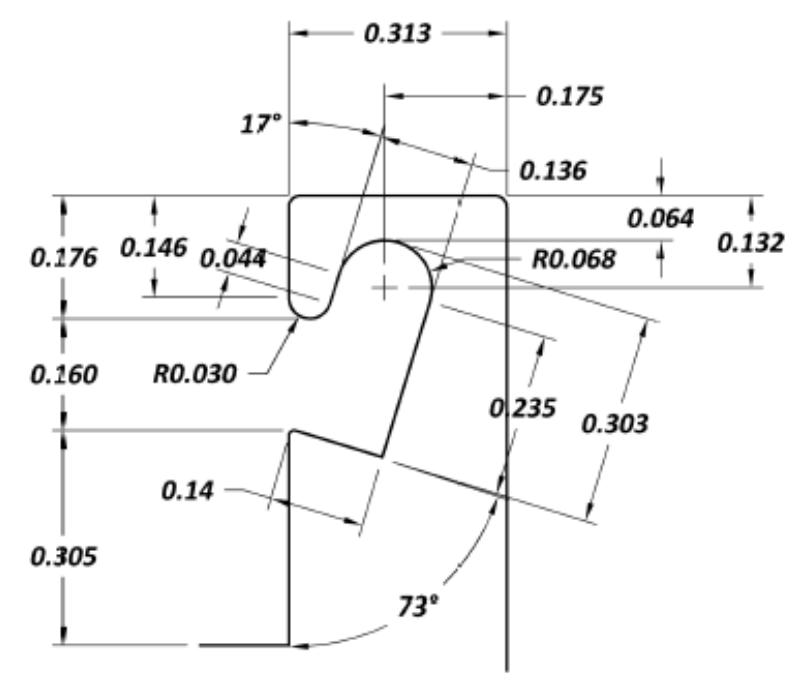

SECTION A

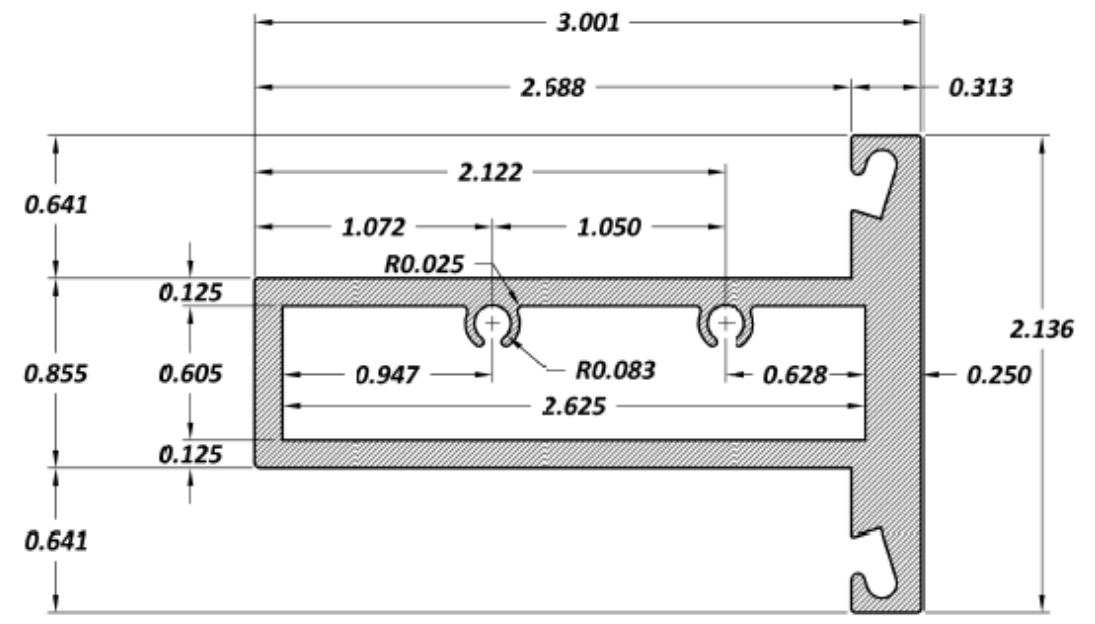
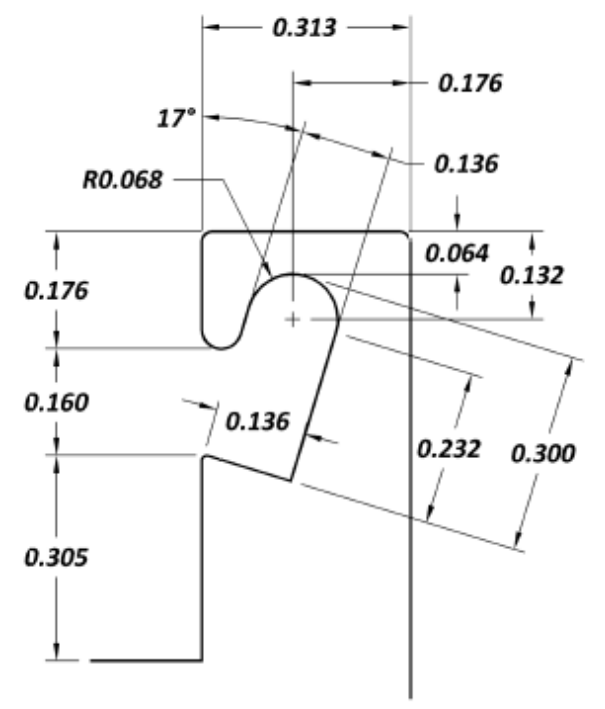

SECTION B

FLORIDA ENGINEERING LLC 4161
TAMIAMI TRAIL, UNIT 101
PORT CHARLOTTE, FLORIDA 33952
(941) 391-5980
www.FLEng.com

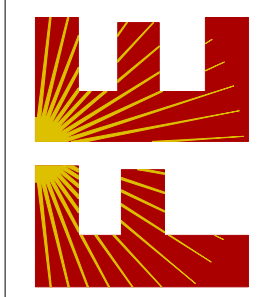

PROJECT NO. 2023126-16
CA CERT. #30782

CONTRACTOR:
TAYLOR MADE
EXTRUSIONS, INC.

PROJECT DESCRIPTION:
MASTER PLAN

DESIGN DATE:	02/12/2024
REVISION 1:	DATE
REVISION 2:	DATE
DRAWN BY:	KHV
SCALE:	NTS

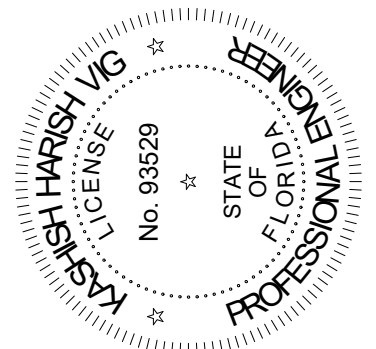

Kashish Harish Vig, P.E. #93529
DATE:

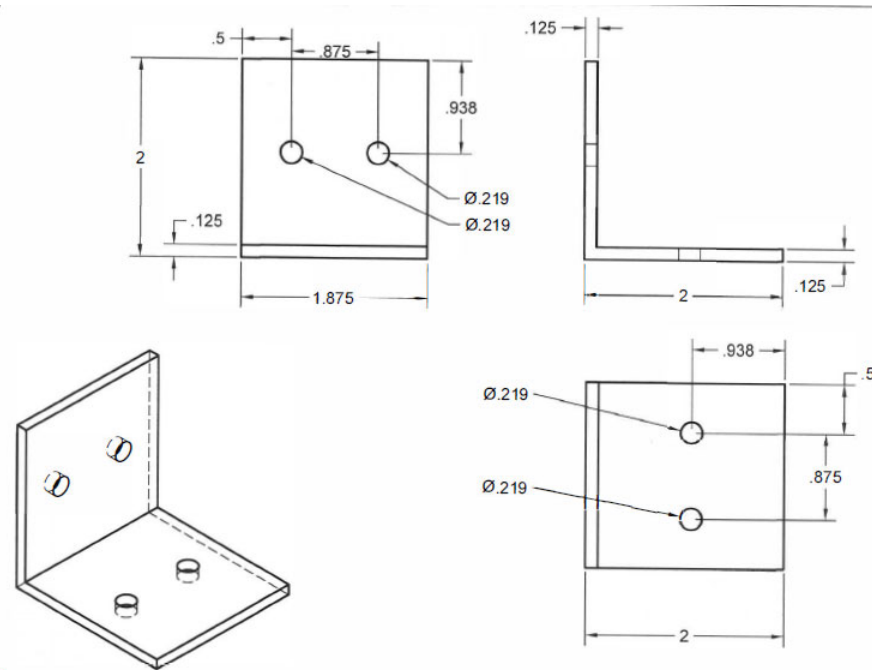

2"X2"X0.125" ANGLE

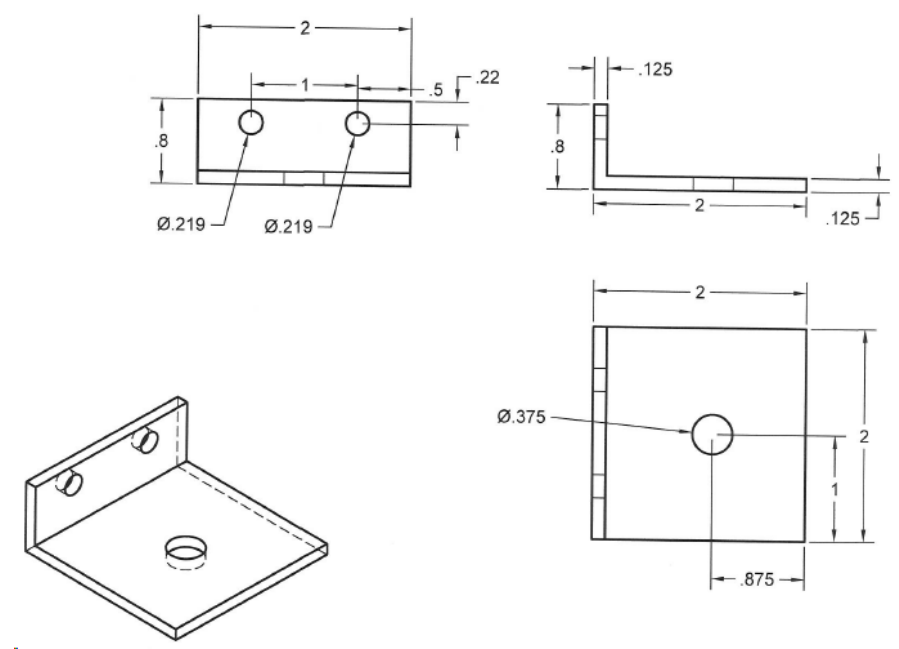

2"X0.8"X0.125" ANGLE

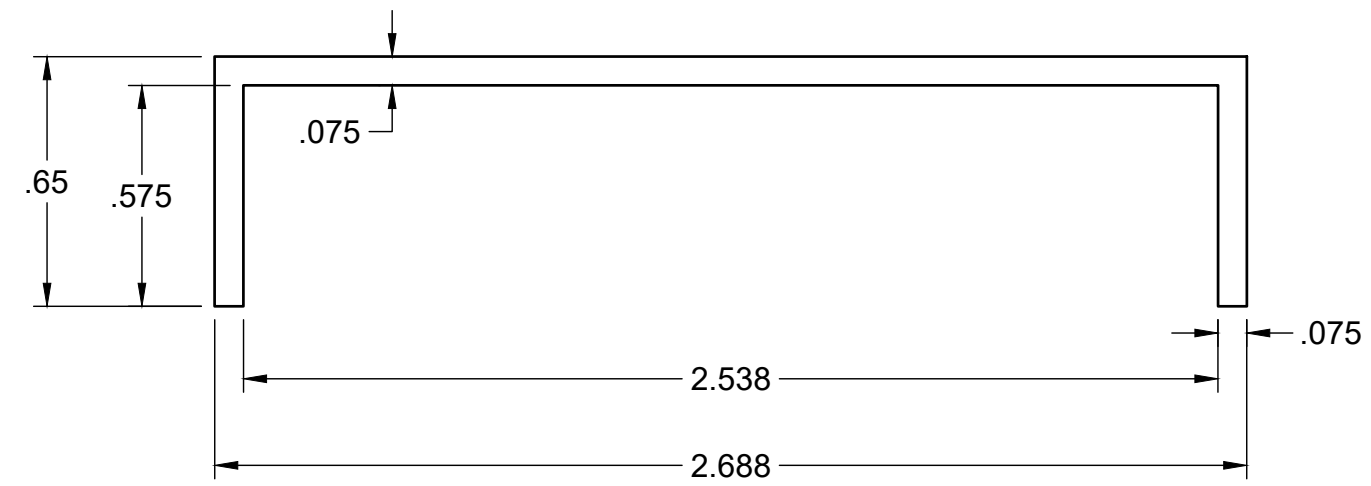

SECTION C

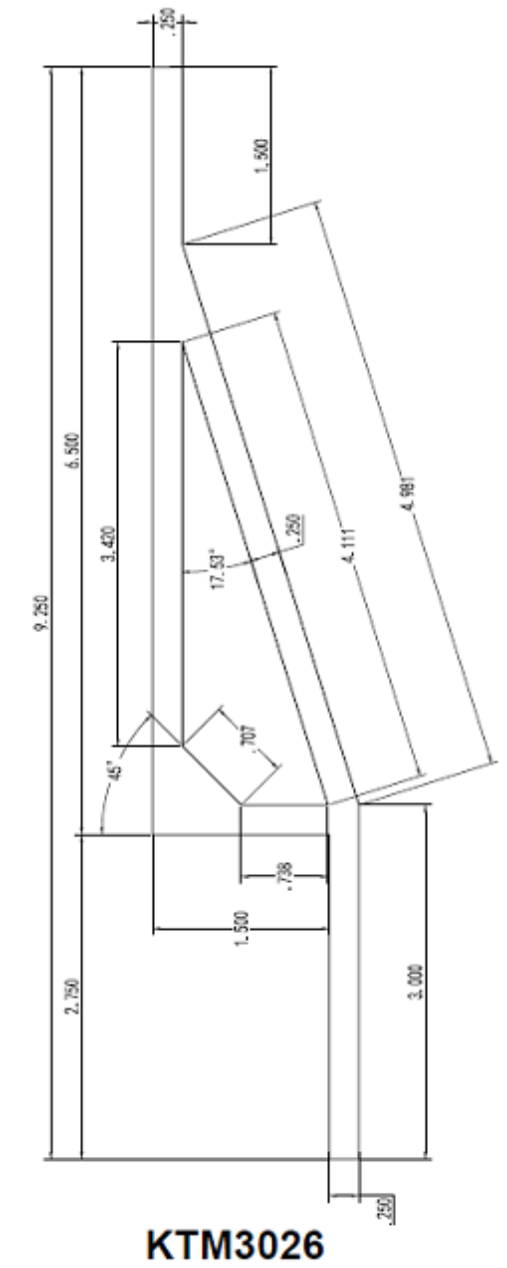

KTM3026

FLORIDA ENGINEERING LLC 4161
TAMIAMI TRAIL, UNIT 101
PORT CHARLOTTE, FLORIDA 33952
(941) 391-5980
www.FLEng.com

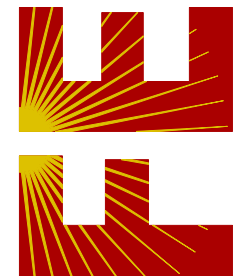

CONTRACTOR:
TAYLOR MADE
EXTRUSIONS, INC.

PROJECT DESCRIPTION:
MASTER PLAN

PROJECT NO. 2023126-16

CA CERT. #30782

DESIGN DATE:	02/12/2024	PAGE :
REVISION 1:	DATE	
REVISION 2:	DATE	5
DRAWN BY:	KHV	
SCALE:	NTS	